

FILE NAME: M:\1738400\_FOREST HOME\HWY\DRAW\1738400\_COV\_01.DGN  
 DATE/TIME: 03-SEP-2009 11:07  
 USER: JBRALINGARD  
 ENG\_NYS00T\_04

DESIGN SUPERVISOR: WRM  
 JOB MANAGER: WRM  
 DESIGNED BY: JRB  
 CHECKED BY: WRM  
 ESTIMATED BY: JRB  
 DRAFTED BY: JRB  
 CHECKED BY: WRM

CONTRACTORS NAME:
AWARD DATE:
COMPLETION DATE:
FINAL ACCEPTANCE DATE:
ENGINEER IN CHARGE:
FINAL COST TOTAL:

**STANDARD SHEETS**  
 NEW YORK STATE DEPARTMENT OF TRANSPORTATION  
 STANDARD SHEETS 203-05, 209-01, 603-01, 604-02,  
 606-04, 606-06, 609-01, 609-02,  
 619-02, 619-04, 619-10, 619-11,  
 619-12, 619-50, 619-60, 619-66,  
 645-01, 645-03, 646-01, 646-02,  
 655-04, 655-07, 670-01, 670-02,  
 685-01

# TOWN OF ITHACA ENGINEERING DEPARTMENT

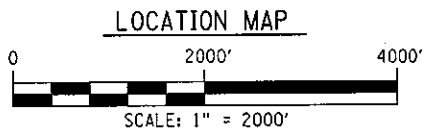
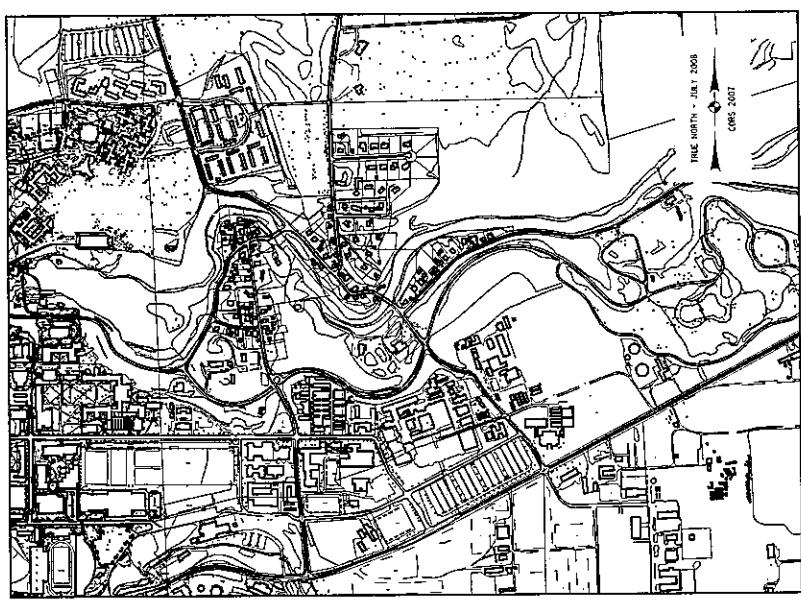

## FOREST HOME TRAFFIC CALMING - PHASE I ENTRANCE FEATURES AND MID-BLOCK SPEED TABLES (PIN: 375509)

TOWN OF ITHACA, NEW YORK  
 SEPTEMBER 2009



INDEX OF DRAWINGS  
 ON SHEET NO. 2

WARNING: IT IS A VIOLATION OF LAW FOR ANY PERSON, UNLESS ACTING UNDER THE DIRECTION OF A LICENSED PROFESSIONAL ENGINEER, ARCHITECT, LANDSCAPE ARCHITECT OR LAND SURVEYOR, TO ALTER AN ITEM IN ANY WAY. IF AN ITEM BEARING THE STAMP OF A LICENSED PROFESSIONAL IS ALTERED, THE ALTERING ENGINEER, ARCHITECT, LANDSCAPE ARCHITECT OR LAND SURVEYOR SHALL STAMP THE DOCUMENT AND INCLUDE THE NOTATION "ALTERED BY" FOLLOWED BY THEIR SIGNATURE, THE DATE OF SUCH ALTERATION, AND A SPECIFIC DESCRIPTION OF THE ALTERATION.

APPROVED BY:		PREPARED BY:	
 HERBERT J. ENGMAN SUPERVISOR		<div style="border: 2px solid blue; padding: 5px; text-align: center; font-weight: bold; color: blue;">FOR COMMENT</div> WILLIAM R. MERWARTH, P.E. N.Y.S.P.E. LIC. NO. 058783	
TOWN OF ITHACA 215 N. TIOGA STREET ITHACA, N.Y. 14850		 McFARLAND-JOHNSON, INC. 49 COURT ST BINGHAMTON, NY 13902	
		DATE SEPT. 2009	



FILE NAME: M:\17384900\_FOREST HOME\HW\DRAW\17384900\_TYP\_SEC.DGN  
 DATE/TIME: 06/05/2010 12:34:56  
 USER: DGNUSER

WRM CHECKED BY JRB DRAFTED BY JRB ESTIMATED BY WRM CHECKED BY TRH DESIGNED BY WRM JOB MANAGER WRM DESIGN SUPERVISOR

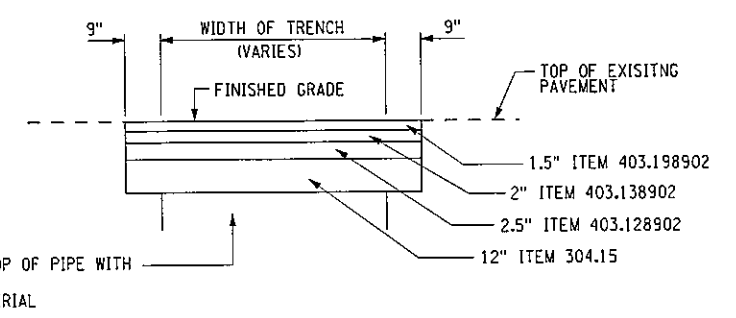
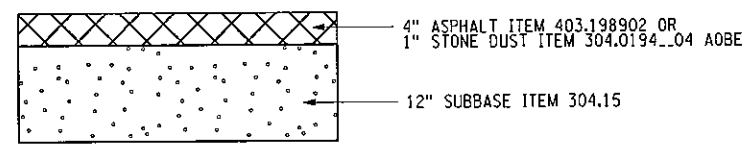
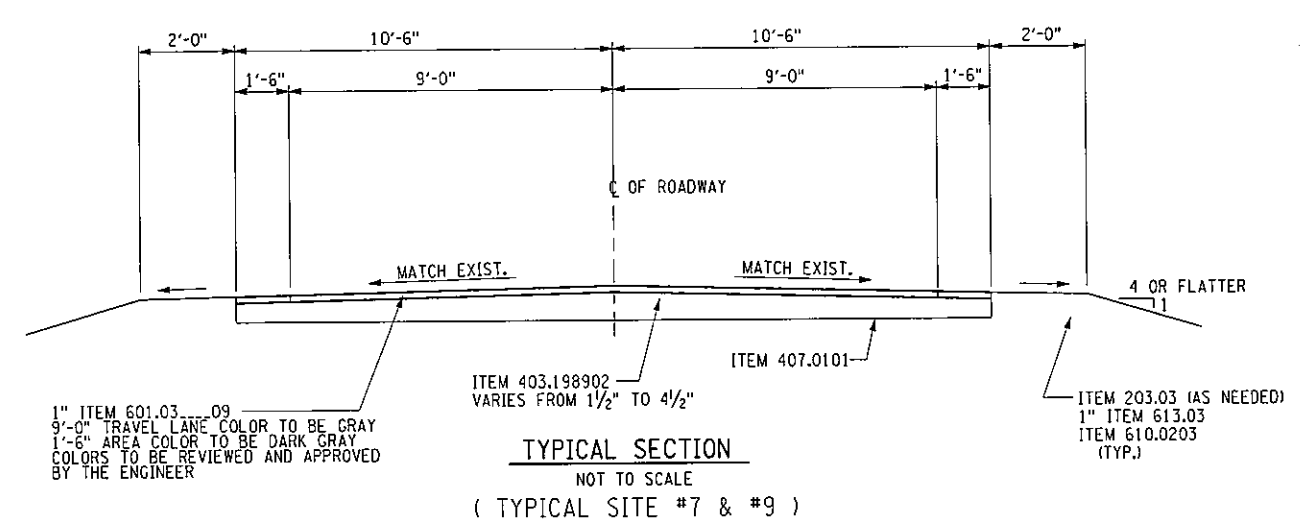
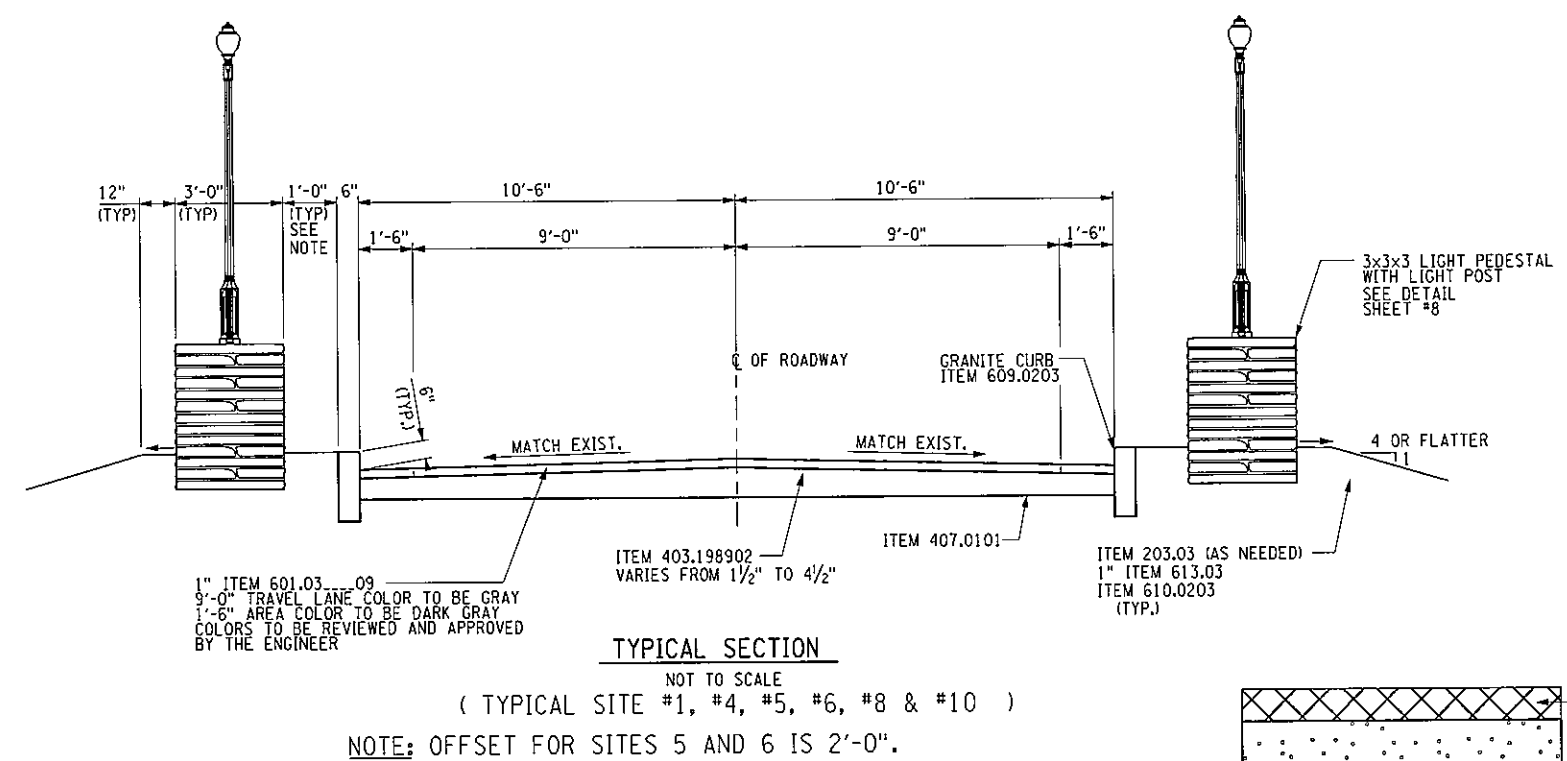
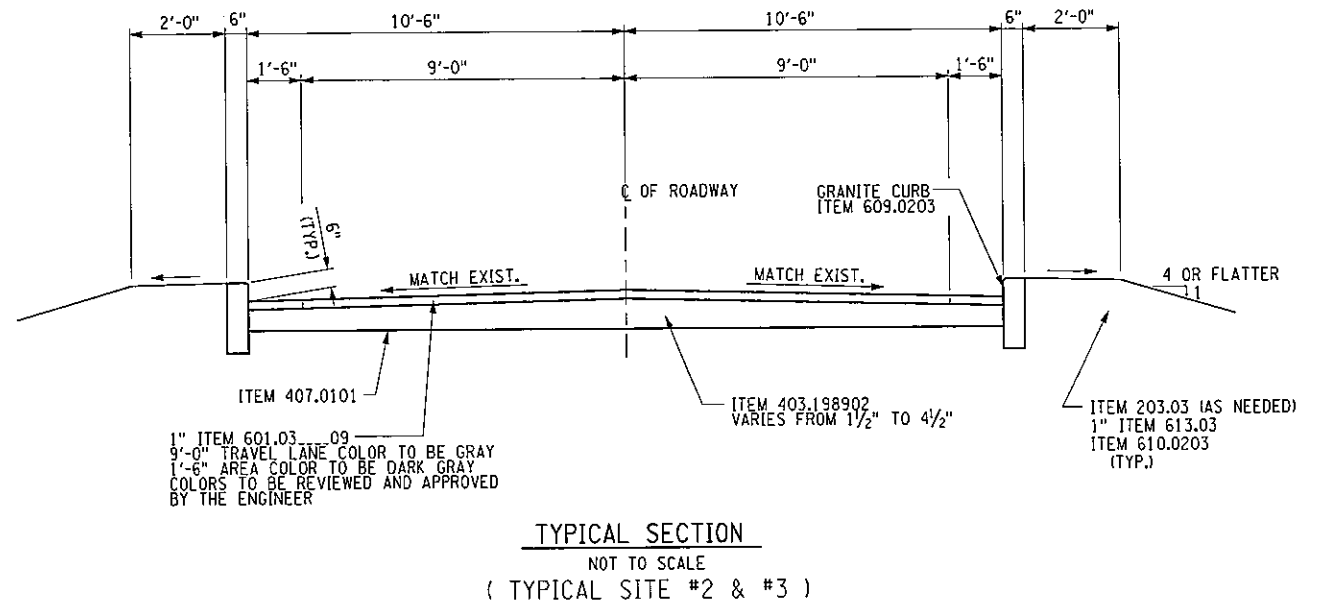
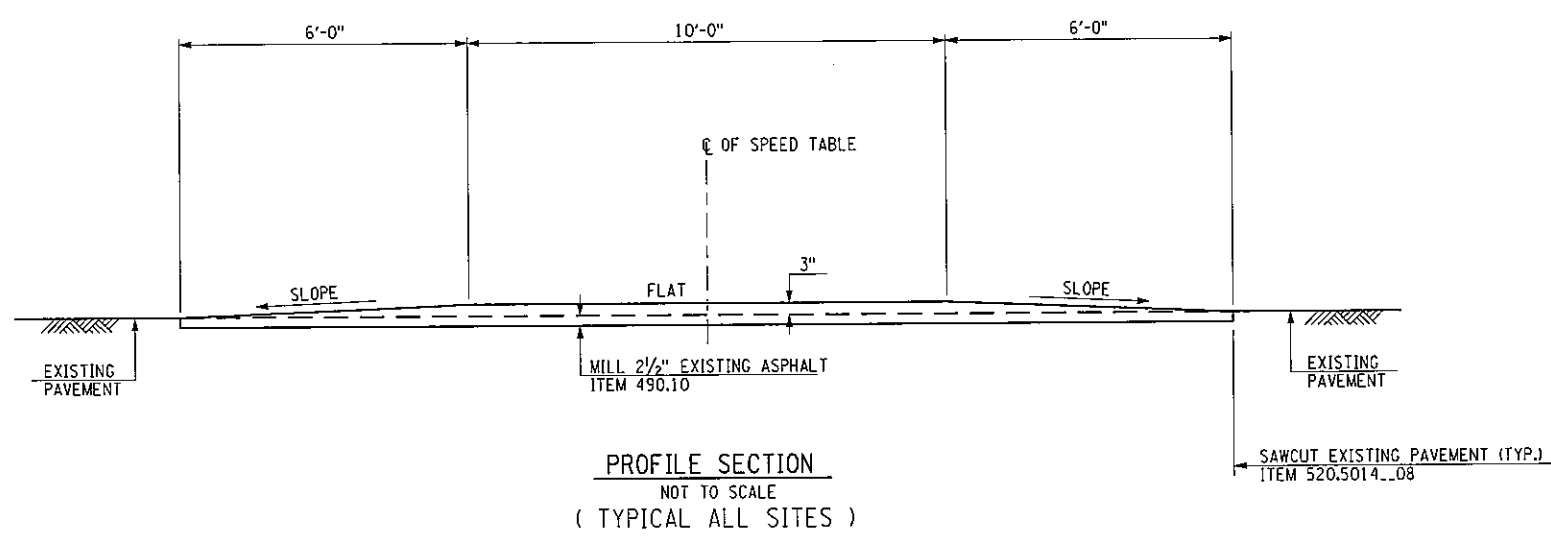

**FOR COMMENT**

IT IS A VIOLATION OF LAW FOR ANY PERSON, UNLESS THEY ARE ACTING UNDER THE DIRECTION OF A LICENSED PROFESSIONAL ENGINEER, ARCHITECT, LANDSCAPE ARCHITECT OR LAND SURVEYOR TO ALTER AN ITEM IN ANY WAY. IF AN ITEM BEARING THE STAMP OF A LICENSED PROFESSIONAL IS ALTERED, THE ALTERING ENGINEER, ARCHITECT, LANDSCAPE ARCHITECT OR LAND SURVEYOR SHALL STAMP THE DOCUMENT AND INCLUDE THE NOTATION "ALTERED BY" FOLLOWED BY THEIR SIGNATURE, THE DATE OF SUCH ALTERATION, AND A SPECIFIC DESCRIPTION OF THE ALTERATION.

PREPARED BY: ON:	ALTERED BY: ON:
AS BUILT REVISIONS DESCRIPTION OF WORK:	
SIGNATURE	DATE
DOCUMENT NAME:	

FOREST HOME TRAFFIC CALMING - PHASE I	PIN 375509
TOWN OF ITHACA	
COUNTY: TOMPKINS	

ALL DIMENSIONS IN ft UNLESS OTHERWISE NOTED	CONTRACT NUMBER
TYPICAL SECTIONS FOREST HOME TRAFFIC CALMING PHASE I	SHEET NO. 3
NEW YORK STATE DEPARTMENT OF TRANSPORTATION REGION 3	

FILE NAME: H:\1738400 FOREST HOME\HWY\DRAW\1738400\_SITE\_PL.DGN  
 DATE/TIME: 08/25/2011 01:23:45G  
 USER: DGN\$USER\$NAME

DESIGN SUPERVISOR: WRM  
 JOB MANAGER: WRM  
 DESIGNED BY: TRH  
 CHECKED BY: WRM  
 ESTIMATED BY: JRB  
 DRAFTED BY: JRB  
 CHECKED BY: WRM

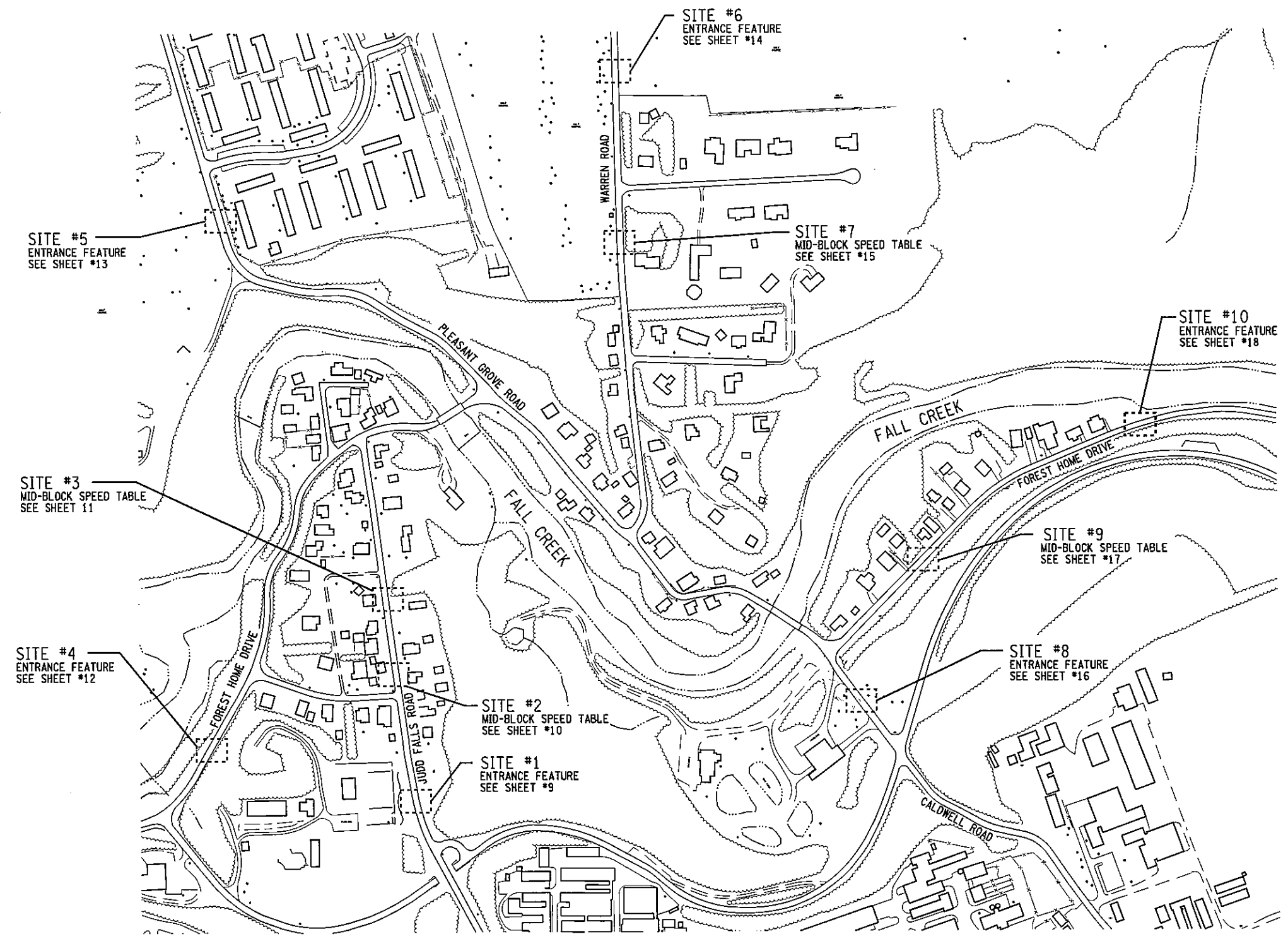

**NOTES**

1. FOR SITE PLANS, SEE SHEETS #9 - #18.
2. FOR LEGEND, SEE SHEETS #2.

**SITE LOCATION PLAN**

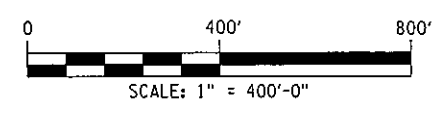

**FOR COMMENT**

IT IS A VIOLATION OF LAW FOR ANY PERSON, UNLESS THEY ARE ACTING UNDER THE DIRECTION OF A LICENSED PROFESSIONAL ENGINEER, ARCHITECT, LANDSCAPE ARCHITECT OR LAND SURVEYOR TO ALTER AN ITEM IN ANY WAY. IF AN ITEM BEARING THE STAMP OF A LICENSED PROFESSIONAL IS ALTERED, THE ALTERING ENGINEER, ARCHITECT, LANDSCAPE ARCHITECT OR LAND SURVEYOR SHALL STAMP THE DOCUMENT AND INCLUDE THE NOTATION "ALTERED BY" FOLLOWED BY THEIR SIGNATURE, THE DATE OF SUCH ALTERATION, AND A SPECIFIC DESCRIPTION OF THE ALTERATION.

PREPARED BY: ON:	ALTERED BY: ON:

AS BUILT REVISIONS  
 DESCRIPTION OF WORK:

SIGNATURE \_\_\_\_\_ DATE \_\_\_\_\_

DOCUMENT NAME:

FOREST HOME TRAFFIC CALMING - PHASE I

TOWN OF ITHACA

COUNTY: TOMPKINS



PIN 375509

ALL DIMENSIONS IN FT UNLESS OTHERWISE NOTED	CONTRACT NUMBER
SITE LOCATION PLAN	
FOREST HOME TRAFFIC CALMING PHASE I	
SHEET NO. 4	

FILE NAME: H:\1738488 FOREST HOME\HW\DRAW\1738488\_DETOUR\_01.DGN  
 DATE/TIME: 06/25/11 10:23:45  
 USER: DGN#USERNAME

DESIGN SUPERVISOR: WRM  
 JOB MANAGER: WRM  
 DESIGNED BY: TRH  
 CHECKED BY: WRM  
 ESTIMATED BY: JRB  
 DRAFTED BY: JRB  
 CHECKED BY: WRM

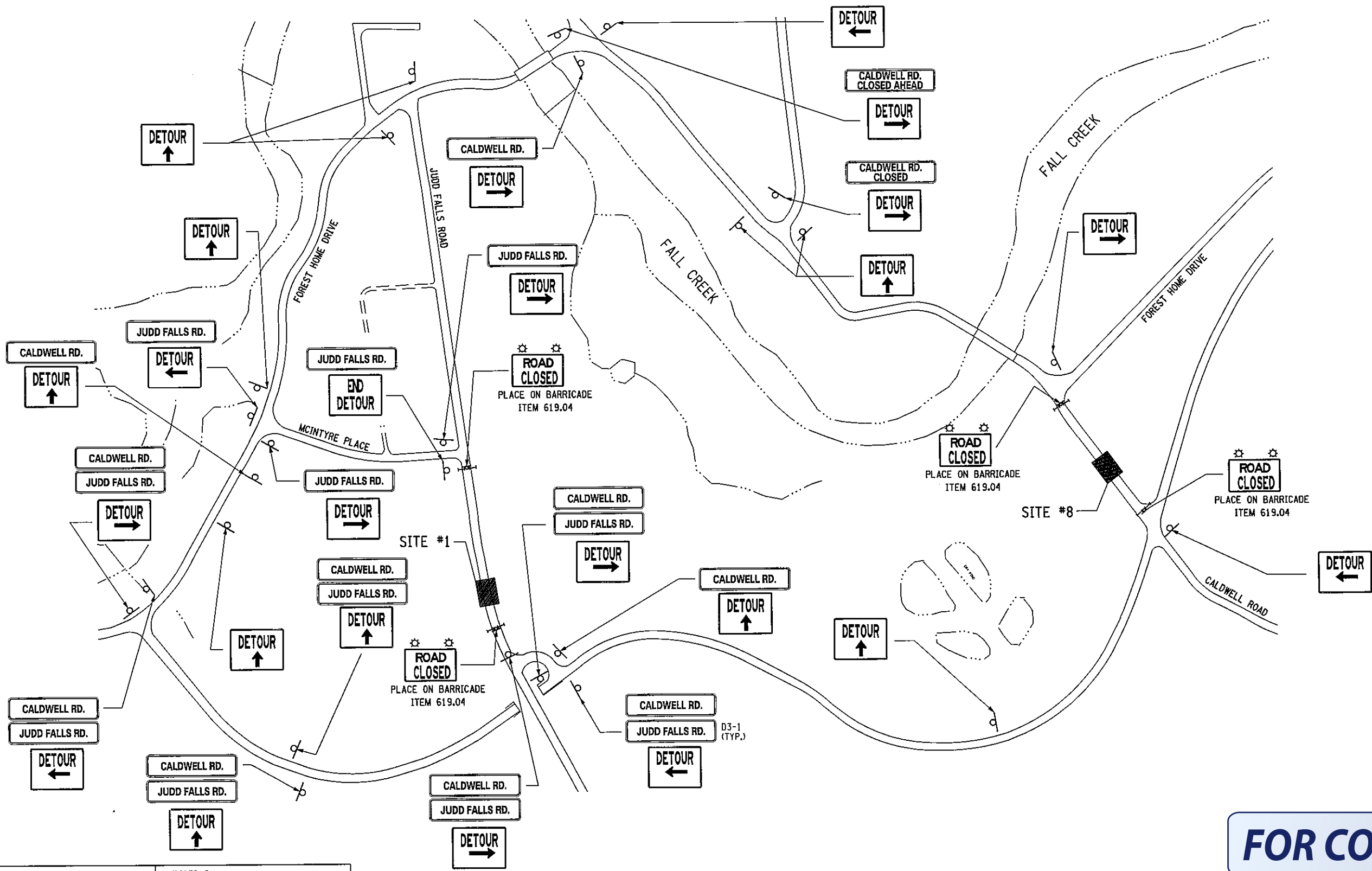

**FOR COMMENT**

**TRAFFIC CONTROL PLAN FOR SITE #1 & #8**  
 NOT TO SCALE

NOTE: MAINTENANCE AND PROTECTION OF TRAFFIC ITEM 619.01

IT IS A VIOLATION OF LAW FOR ANY PERSON, UNLESS THEY ARE ACTING UNDER THE DIRECTION OF A LICENSED PROFESSIONAL ENGINEER, ARCHITECT, LANDSCAPE ARCHITECT OR LAND SURVEYOR TO ALTER AN ITEM IN ANY WAY. IF AN ITEM BEARING THE STAMP OF A LICENSED PROFESSIONAL IS ALTERED, THE ALTERING ENGINEER, ARCHITECT, LANDSCAPE ARCHITECT OR LAND SURVEYOR SHALL STAMP THE DOCUMENT AND INCLUDE THE NOTATION "ALTERED BY" FOLLOWED BY THEIR SIGNATURE, THE DATE OF SUCH ALTERATION, AND A SPECIFIC DESCRIPTION OF THE ALTERATION.

PREPARED BY: ON:	ALTERED BY: ON:

AS BUILT REVISIONS DESCRIPTION OF WORK:	FOREST HOME TRAFFIC CALMING - PHASE I
SIGNATURE _____	TOWN OF ITHACA
DATE _____	COUNTY: TOMPKINS
DOCUMENT NAME:	

PIN 375509



--	--

ALL DIMENSIONS IN FT UNLESS OTHERWISE NOTED	CONTRACT NUMBER
<b>TRAFFIC CONTROL PLAN #1</b> FOREST HOME TRAFFIC CALMING PHASE I	SHEET NO. 5
NEW YORK STATE DEPARTMENT OF TRANSPORTATION REGION 3	

FILE NAME: M:\1738400 FOREST HOME\HYDRA\1738400\_DETOUTR\_02.DGN  
 DATE/TIME: 03/28/2011 10:23:45  
 USER: FDGN\USER  
 DESIGN SUPERVISOR: WRM  
 JOB MANAGER: WRM  
 DESIGNED BY: TRH  
 CHECKED BY: WRM  
 ESTIMATED BY: JRB  
 DRAFTED BY: JRB  
 CHECKED BY: WRM  
 FILE NAME: M:\1738400 FOREST HOME\HYDRA\1738400\_DETOUTR\_02.DGN  
 DATE/TIME: 03/28/2011 10:23:45  
 USER: FDGN\USER  
 DESIGN SUPERVISOR: WRM  
 JOB MANAGER: WRM  
 DESIGNED BY: TRH  
 CHECKED BY: WRM  
 ESTIMATED BY: JRB  
 DRAFTED BY: JRB  
 CHECKED BY: WRM

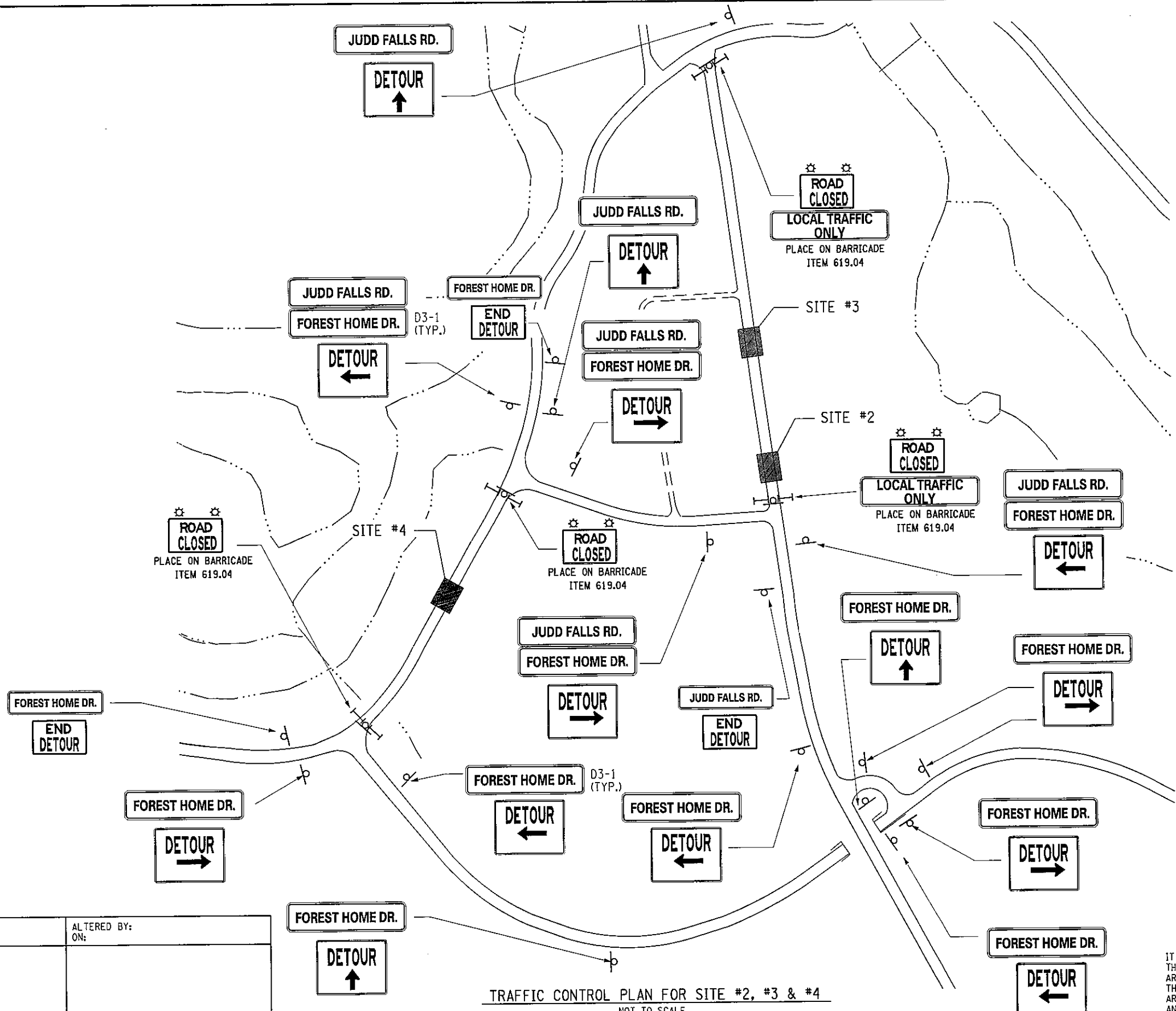

**FOR COMMENT**

IT IS A VIOLATION OF LAW FOR ANY PERSON, UNLESS THEY ARE ACTING UNDER THE DIRECTION OF A LICENSED PROFESSIONAL ENGINEER, ARCHITECT, LANDSCAPE ARCHITECT OR LAND SURVEYOR TO ALTER AN ITEM IN ANY WAY. IF AN ITEM BEARING THE STAMP OF A LICENSED PROFESSIONAL IS ALTERED, THE ALTERING ENGINEER, ARCHITECT, LANDSCAPE ARCHITECT OR LAND SURVEYOR SHALL STAMP THE DOCUMENT AND INCLUDE THE NOTATION "ALTERED BY" FOLLOWED BY THEIR SIGNATURE, THE DATE OF SUCH ALTERATION, AND A SPECIFIC DESCRIPTION OF THE ALTERATION.

PREPARED BY: ON:	ALTERED BY: ON:

**TRAFFIC CONTROL PLAN FOR SITE #2, #3 & #4**  
 NOT TO SCALE  
 NOTE: MAINTENANCE AND PROTECTION OF TRAFFIC ITEM 619.01

AS BUILT REVISIONS DESCRIPTION OF WORK:	FOREST HOME TRAFFIC CALMING - PHASE I  TOWN OF ITHACA COUNTY: TOMPKINS	PIN 375509	ALL DIMENSIONS IN FT UNLESS OTHERWISE NOTED	CONTRACT NUMBER
SIGNATURE _____ DATE _____			<b>TRAFFIC CONTROL PLAN #2</b> FOREST HOME TRAFFIC CALMING PHASE I	SHEET NO. 6
NEW YORK STATE DEPARTMENT OF TRANSPORTATION REGION 3				

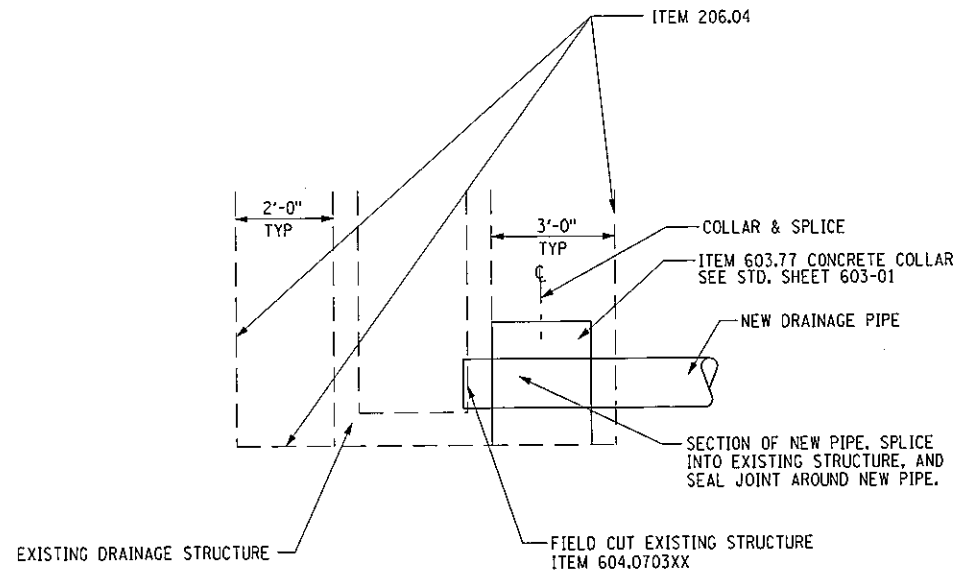
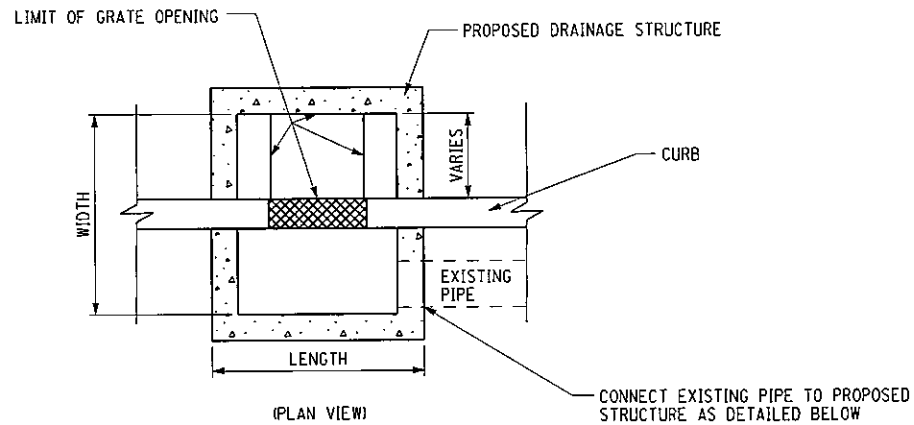

**DETAIL FOR PLACING A NEW DRAIN PIPE  
INTO AN EXISTING STRUCTURE**  
NOT TO SCALE

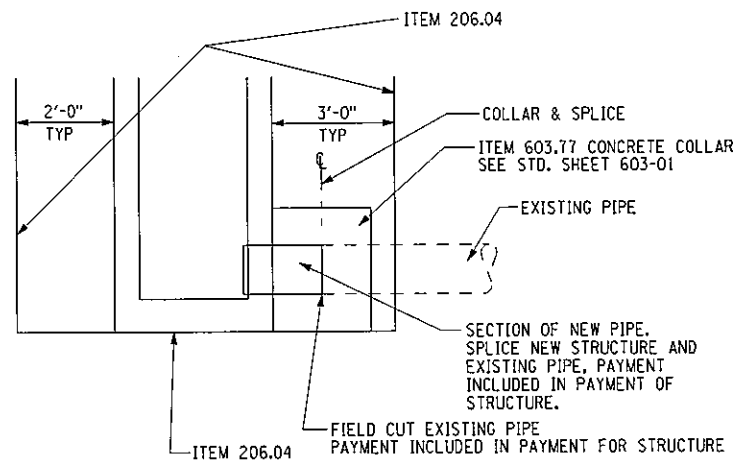

**DETAIL FOR PLACING A NEW STRUCTURE  
OVER AN EXISTING PIPE**  
NOT TO SCALE

**FOR COMMENT**

FILE NAME: M:\17384000\_FOREST HOME\HYDRO\DRAW\17384000\_DRAIN\_DET.DGN  
DATE/TIME: 06/05/2010 12:34:56  
USER: DGN\USERNAME

DESIGN SUPERVISOR: WRM  
JOB MANAGER: WRM  
DESIGNED BY: TRH  
CHECKED BY: WRM  
ESTIMATED BY: JRB  
DRAFTED BY: JRB  
CHECKED BY: WRM

PREPARED BY: ON:	ALTERED BY: ON:
<p>IT IS A VIOLATION OF LAW FOR ANY PERSON, UNLESS THEY ARE ACTING UNDER THE DIRECTION OF A LICENSED PROFESSIONAL ENGINEER, ARCHITECT, LANDSCAPE ARCHITECT OR LAND SURVEYOR TO ALTER AN ITEM IN ANY WAY. IF AN ITEM BEARING THE STAMP OF A LICENSED PROFESSIONAL IS ALTERED, THE ALTERING ENGINEER, ARCHITECT, LANDSCAPE ARCHITECT OR LAND SURVEYOR SHALL STAMP THE DOCUMENT AND INCLUDE THE NOTATION "ALTERED BY" FOLLOWED BY THEIR SIGNATURE, THE DATE OF SUCH ALTERATION, AND A SPECIFIC DESCRIPTION OF THE ALTERATION.</p>	
AS BUILT REVISIONS DESCRIPTION OF WORK:	FOREST HOME TRAFFIC CALMING - PHASE I
SIGNATURE _____	DATE _____
DOCUMENT NAME:	TOWN OF ITHACA COUNTY: TOMPKINS

AS BUILT REVISIONS  
DESCRIPTION OF WORK:

FOREST HOME TRAFFIC CALMING - PHASE I

TOWN OF ITHACA  
COUNTY: TOMPKINS

SIGNATURE \_\_\_\_\_ DATE \_\_\_\_\_

DOCUMENT NAME:

FOREST HOME TRAFFIC CALMING - PHASE I

TOWN OF ITHACA  
COUNTY: TOMPKINS

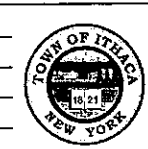

PIN 375509

ALL DIMENSIONS IN FT UNLESS OTHERWISE NOTED

**DRAINAGE DETAILS**  
FOREST HOME TRAFFIC CALMING  
PHASE I

CONTRACT NUMBER

SHEET NO. 7

NEW YORK STATE DEPARTMENT OF TRANSPORTATION REGION 3

FILE NAME: A:\1730400 FOREST HOME\HY\DRANK\1730400.ERD.DGN  
 DATE/TIME: 08/11/2011 10:13:45  
 USER: DGN\$USER\$

WRM CHECKED BY WRM DRAFTED BY JRB ESTIMATED BY JRB DESIGNED BY TRH JOB MANAGER WRM DESIGN SUPERVISOR WRM

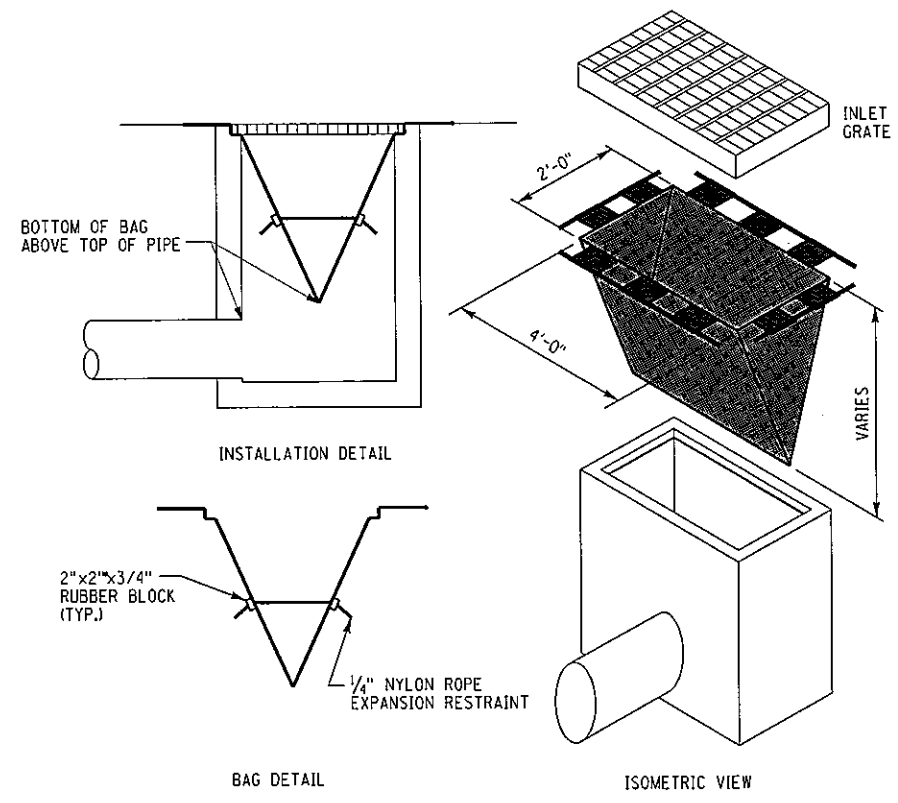

**TEMPORARY SEDIMENT FILTER BAG DETAIL**  
 ITEM 209.11...10  
 NOT TO SCALE

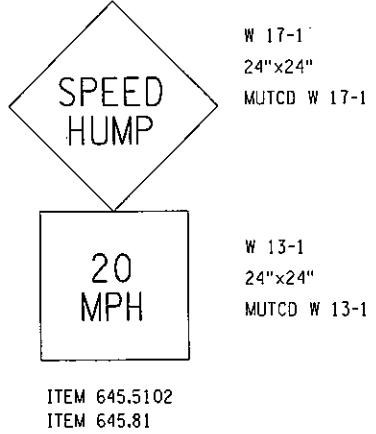

**SIGN ASSEMBLY DETAIL**  
 NOT TO SCALE

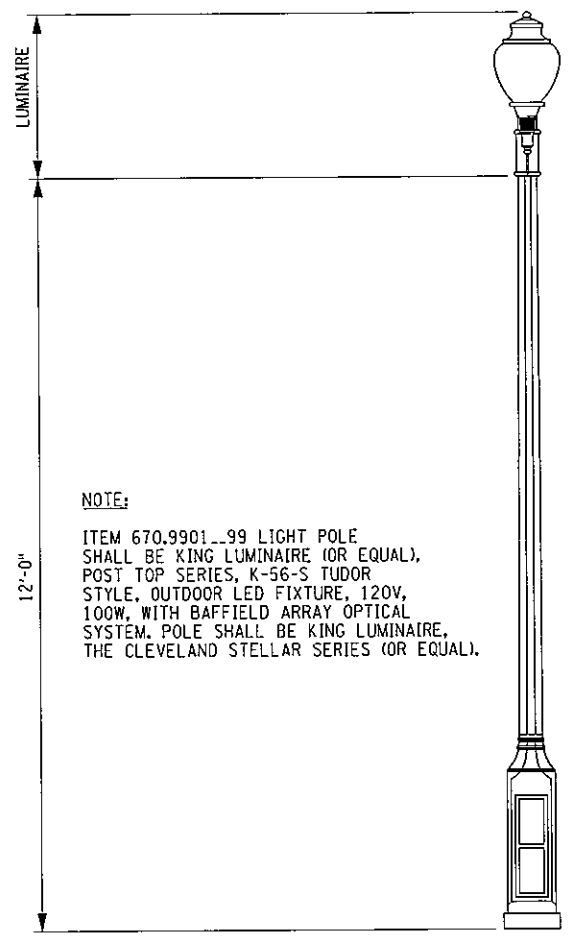

**NOTE:**  
 ITEM 670.9901...99 LIGHT POLE SHALL BE KING LUMINAIRE (OR EQUAL), POST TOP SERIES, K-56-S TUDOR STYLE, OUTDOOR LED FIXTURE, 120V, 100W, WITH BAFFLED ARRAY OPTICAL SYSTEM. POLE SHALL BE KING LUMINAIRE, THE CLEVELAND STELLAR SERIES (OR EQUAL).

**LIGHT POLE DETAIL**  
 ITEM 670.9901...99  
 NOT TO SCALE

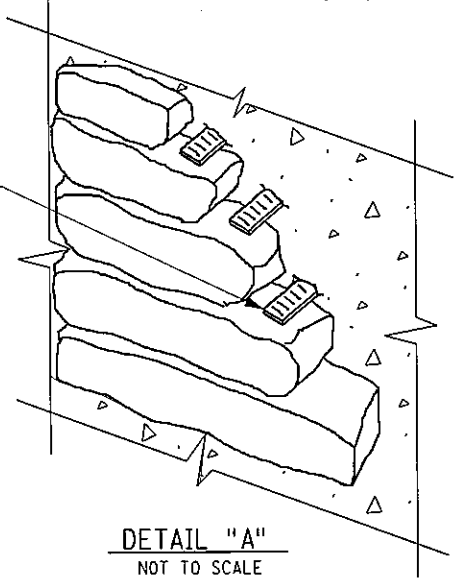

**DETAIL "A"**  
 NOT TO SCALE

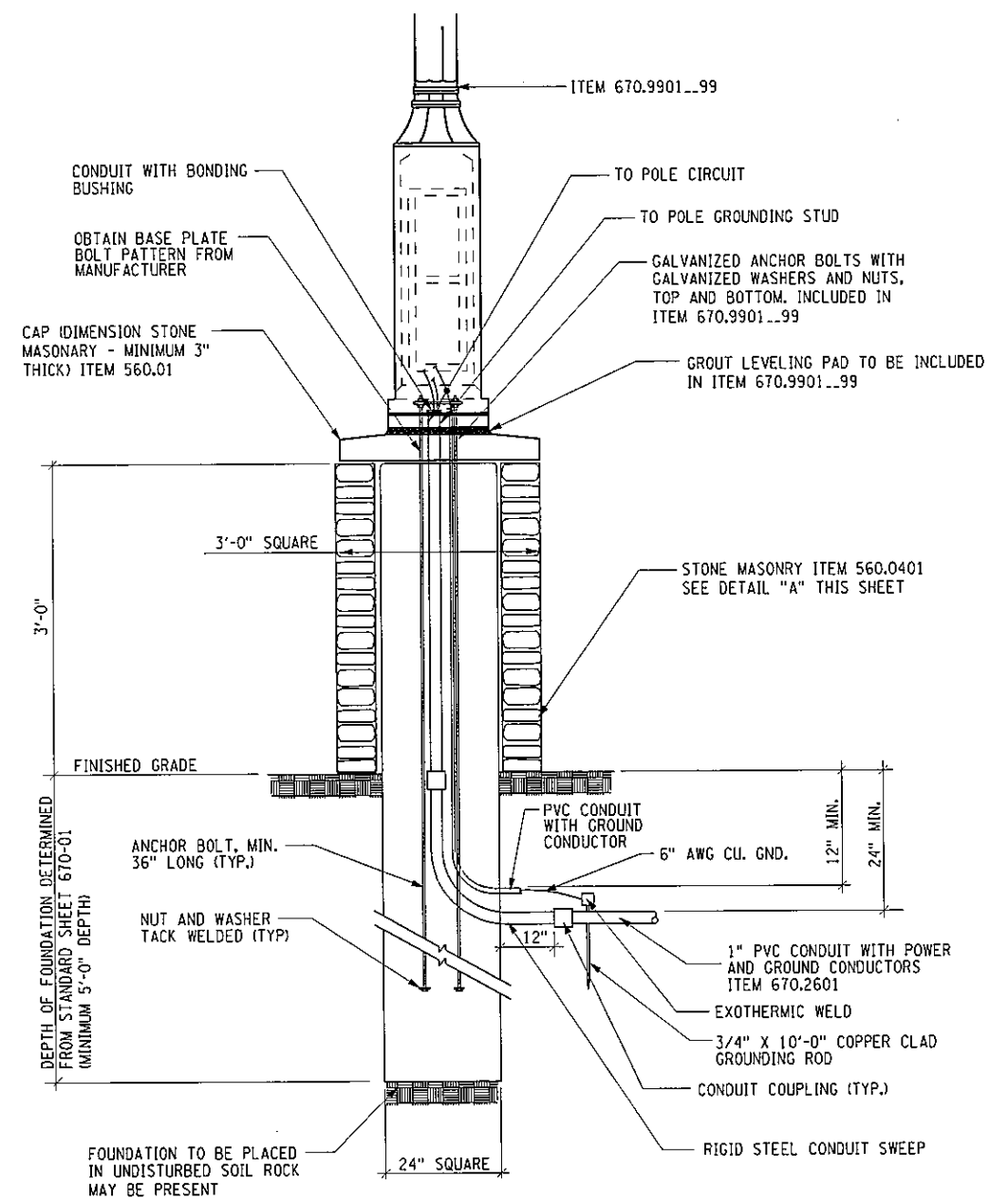

**NOTE:** SUBSURFACE ROCK MAY BE PRESENT AT FOUNDATION LOCATIONS. THE CONTRACTOR SHALL BE PREPARED FOR THIS CONDITION.

**LIGHT PEDESTAL FOUNDATION DETAIL**  
 ITEM 670.0108  
 NOT TO SCALE

**FOR COMMENT**

IT IS A VIOLATION OF LAW FOR ANY PERSON, UNLESS THEY ARE ACTING UNDER THE DIRECTION OF A LICENSED PROFESSIONAL ENGINEER, ARCHITECT, LANDSCAPE ARCHITECT OR LAND SURVEYOR TO ALTER AN ITEM IN ANY WAY. IF AN ITEM BEARING THE STAMP OF A LICENSED PROFESSIONAL IS ALTERED, THE ALTERING ENGINEER, ARCHITECT, LANDSCAPE ARCHITECT OR LAND SURVEYOR SHALL STAMP THE DOCUMENT AND INCLUDE THE NOTATION "ALTERED BY" FOLLOWED BY THEIR SIGNATURE, THE DATE OF SUCH ALTERATION, AND A SPECIFIC DESCRIPTION OF THE ALTERATION.

PREPARED BY: ON:	ALTERED BY: ON:
SIGNATURE _____ DATE _____	
DOCUMENT NAME:	

AS BUILT REVISIONS DESCRIPTION OF WORK:	FOREST HOME TRAFFIC CALMING - PHASE I
TOWN OF ITHACA	COUNTY: TOMPKINS

PIN 375509	CONTRACT NUMBER
TOWN OF ITHACA	SHEET NO. 8

ALL DIMENSIONS IN FT UNLESS OTHERWISE NOTED
MISCELLANEOUS DETAILS FOREST HOME TRAFFIC CALMING PHASE I

NEW YORK STATE DEPARTMENT OF TRANSPORTATION REGION 3
--

FILE NAME: M:\1736400 FOREST HOME\HY\DRAW\40 SCALE PLANS\1736400\_S1.DGN  
 DATE/TIME: DGN\$SYTIME0123456  
 USER: DGN\$USER\$NAME

WRM CHECKED BY JRB DRAFTED BY JRB ESTIMATED BY WRM CHECKED BY TRH DESIGNED BY WRM JOB MANAGER WRM DESIGN SUPERVISOR WRM

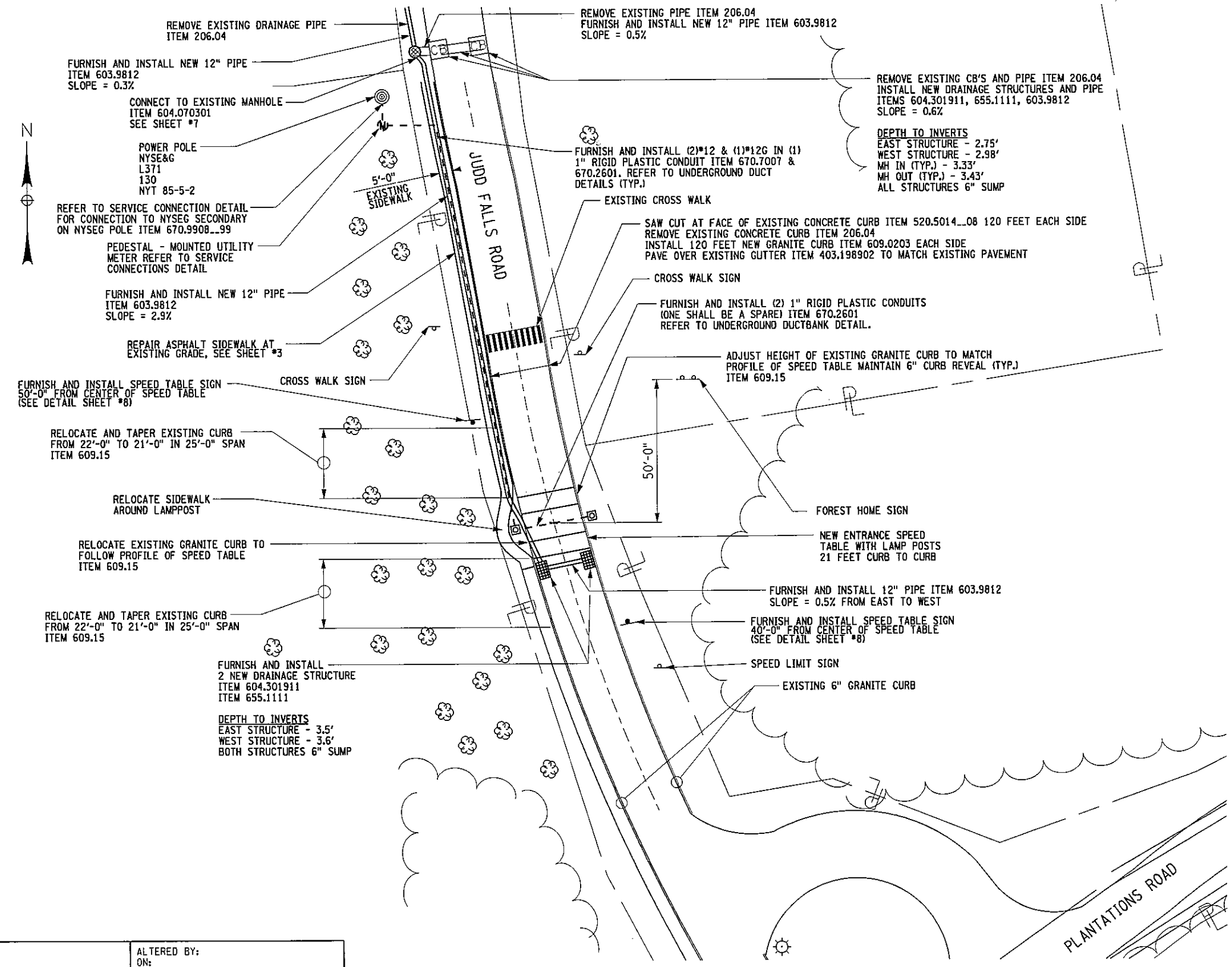

**NOTES**

1. FOR SITE LOCATION PLAN, SEE SHEET #4.
2. FOR LEGEND, SEE SHEET #2.
3. FOR PAVEMENT MARKINGS, SEE SHEET #19.
4. FOR DRAINAGE DETAILS, SEE SHEET #7.
5. FOR ELECTRICAL DETAILS, SEE SHEET #8 & #20.
6. PRIOR TO ANY CONSTRUCTION THE CONTRACTOR SHALL LAYOUT AND MARK THE LOCATION OF EACH SPEED TABLE. NO CONSTRUCTION SHALL BEGIN UNTIL ENGINEER APPROVES MARKED OUT LOCATION.
7. SILT FENCE (ITEM 209.13) SHALL BE USED AT ALL SITES AS DIRECTED BY THE ENGINEER.
8. AT ALL ENTRANCE FEATURES FURNISH AND INSTALL 2 NEW 12'-0" LIGHT POLES AND LED FIXTURES ITEM 670.9901...99.

**FOR COMMENT**

**SITE #1 - ENTRANCE FEATURE LAYOUT**

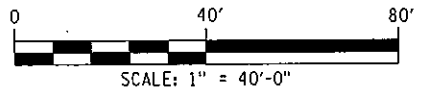

IT IS A VIOLATION OF LAW FOR ANY PERSON, UNLESS THEY ARE ACTING UNDER THE DIRECTION OF A LICENSED PROFESSIONAL ENGINEER, ARCHITECT, LANDSCAPE ARCHITECT OR LAND SURVEYOR TO ALTER AN ITEM IN ANY WAY. IF AN ITEM BEARING THE STAMP OF A LICENSED PROFESSIONAL IS ALTERED, THE ALTERING ENGINEER, ARCHITECT, LANDSCAPE ARCHITECT OR LAND SURVEYOR SHALL STAMP THE DOCUMENT AND INCLUDE THE NOTATION "ALTERED BY" FOLLOWED BY THEIR SIGNATURE, THE DATE OF SUCH ALTERATION, AND A SPECIFIC DESCRIPTION OF THE ALTERATION.

PREPARED BY: ON:	ALTERED BY: ON:

AS BUILT REVISIONS DESCRIPTION OF WORK:	FOREST HOME TRAFFIC CALMING - PHASE I
SIGNATURE _____	DATE _____
DOCUMENT NAME:	

TOWN OF ITHACA COUNTY: TOMPKINS	PIN 375509
------------------------------------	------------



ALL DIMENSIONS IN FT UNLESS OTHERWISE NOTED  <b>SITE #1 - ENTRANCE FEATURE LAYOUT</b> FOREST HOME TRAFFIC CALMING PHASE I	CONTRACT NUMBER  SHEET NO. 9
---	------------------------------------

FILE NAME: \\M:\1738400 FOREST HOME\HY\DRW\48 SCALE PLANS\1738400\_S2.DWG  
 DATE/TIME: 06/03/2013 12:45:56  
 USER: DGN\USER\NAME  
 DESIGN SUPERVISOR: WRM  
 JOB MANAGER: WRM  
 DESIGNED BY: TRH  
 CHECKED BY: WRM  
 ESTIMATED BY: JRB  
 DRAFTED BY: JRB  
 CHECKED BY: WRM



- NOTES**
1. FOR SITE LOCATION PLAN, SEE SHEET #4.
  2. FOR LEGEND, SEE SHEET #2.
  3. FOR PAVEMENT MARKINGS, SEE SHEET #19.
  4. FOR DRAINAGE DETAILS, SEE SHEET #7.
  5. PRIOR TO ANY CONSTRUCTION THE CONTRACTOR SHALL LAYOUT AND MARK THE LOCATION OF EACH SPEED TABLE. NO CONSTRUCTION SHALL BEGIN UNTIL ENGINEER APPROVES MARKED OUT LOCATION.
  6. SILT FENCE (ITEM 209.13) SHALL BE USED AT ALL SITES AS DIRECTED BY THE ENGINEER.

**FOR COMMENT**

PREPARED BY: ON:	ALTERED BY: ON:

**SITE #2 - MID-BLOCK SPEED TABLE LAYOUT**

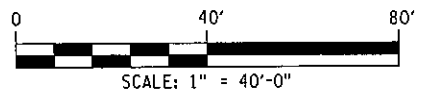

AS BUILT REVISIONS DESCRIPTION OF WORK:	FOREST HOME TRAFFIC CALMING - PHASE I	PIN 375509	ALL DIMENSIONS IN FT UNLESS OTHERWISE NOTED	CONTRACT NUMBER
SIGNATURE	DATE	TOWN OF ITHACA COUNTY: TOMPKINS	<b>SITE #2 - MID-BLOCK SPEED TABLE LAYOUT</b> FOREST HOME TRAFFIC CALMING PHASE I	SHEET NO. 10
DOCUMENT NAME:				NEW YORK STATE DEPARTMENT OF TRANSPORTATION REGION 3

IT IS A VIOLATION OF LAW FOR ANY PERSON, UNLESS THEY ARE ACTING UNDER THE DIRECTION OF A LICENSED PROFESSIONAL ENGINEER, ARCHITECT, LANDSCAPE ARCHITECT OR LAND SURVEYOR TO ALTER AN ITEM IN ANY WAY. IF AN ITEM BEARING THE STAMP OF A LICENSED PROFESSIONAL IS ALTERED, THE ALTERING ENGINEER, ARCHITECT, LANDSCAPE ARCHITECT OR LAND SURVEYOR SHALL STAMP THE DOCUMENT AND INCLUDE THE NOTATION "ALTERED BY" FOLLOWED BY THEIR SIGNATURE, THE DATE OF SUCH ALTERATION, AND A SPECIFIC DESCRIPTION OF THE ALTERATION.

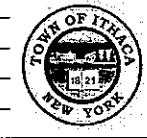

FILE NAME: M:\1738400 FOREST HOME\NY\DRAW\40 SCALE PLANS\1738400\_03.DGN  
 DATE/TIME = DGN\$SYTIME\0123456  
 USER = DGN\$USER\$NAME

DESIGN SUPERVISOR: WRM JOB MANAGER: WRM DESIGNED BY: TRH CHECKED BY: WRM ESTIMATED BY: JRB DRAFTED BY: JRB CHECKED BY: WRM

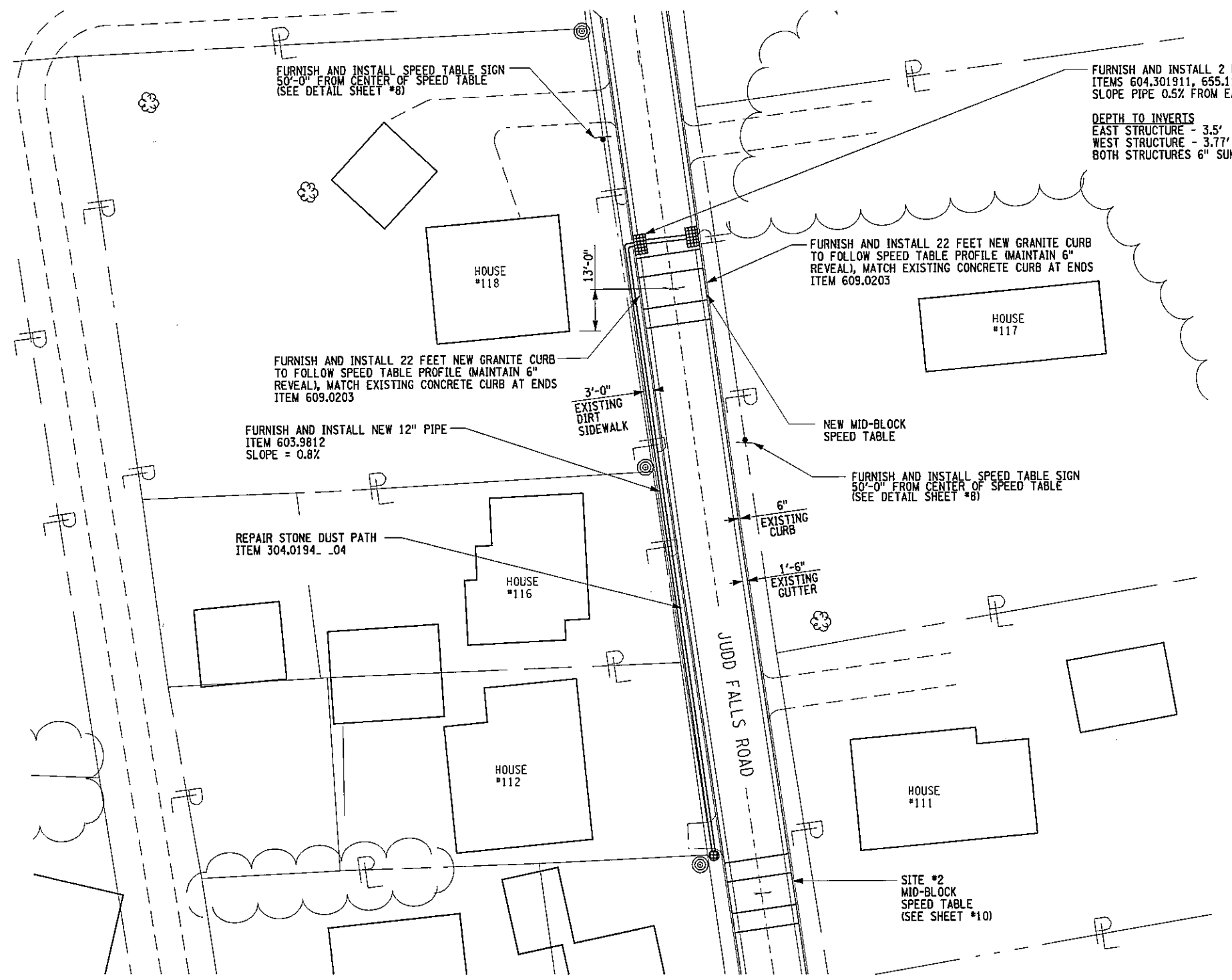

**NOTES**

1. FOR SITE LOCATION PLAN, SEE SHEET #4.
2. FOR LEGEND, SEE SHEET #2.
3. FOR PAVEMENT MARKINGS, SEE SHEET #19.
4. FOR DRAINAGE DETAILS, SEE SHEET #7.
5. PRIOR TO ANY CONSTRUCTION THE CONTRACTOR SHALL LAYOUT AND MARK THE LOCATION OF EACH SPEED TABLE. NO CONSTRUCTION SHALL BEGIN UNTIL ENGINEER APPROVES MARKED OUT LOCATION.
6. SILT FENCE (ITEM 209.13) SHALL BE USED AT ALL SITES AS DIRECTED BY THE ENGINEER.

**FOR COMMENT**

**SITE #3 MID-BLOCK SPEED TABLE LAYOUT**

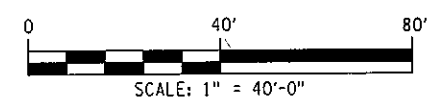

PREPARED BY: ON:	ALTERED BY: ON:

AS BUILT REVISIONS DESCRIPTION OF WORK:	FOREST HOME TRAFFIC CALMING - PHASE I	PIN 375509	ALL DIMENSIONS IN FT UNLESS OTHERWISE NOTED	CONTRACT NUMBER	
SIGNATURE _____ DATE _____	TOWN OF ITHACA COUNTY: TOMPKINS		<b>SITE #3 - MID-BLOCK SPEED TABLE LAYOUT</b> FOREST HOME TRAFFIC CALMING PHASE I	SHEET NO. 11	
NEW YORK STATE DEPARTMENT OF TRANSPORTATION REGION 3					

FILE NAME: M:\17384000 FOREST HOME\HY\DRAW\40 SCALE PLANS\17384000\_S4.DGN  
 DATE/TIME: 08/21/2013 12:45:56  
 USER: DONSUSERNAME

DESIGN SUPERVISOR: WRM  
 JOB MANAGER: WRM  
 DESIGNED BY: TRH  
 CHECKED BY: WRM  
 ESTIMATED BY: JRB  
 DRAFTED BY: JRB  
 CHECKED BY: WRM  
 WRM

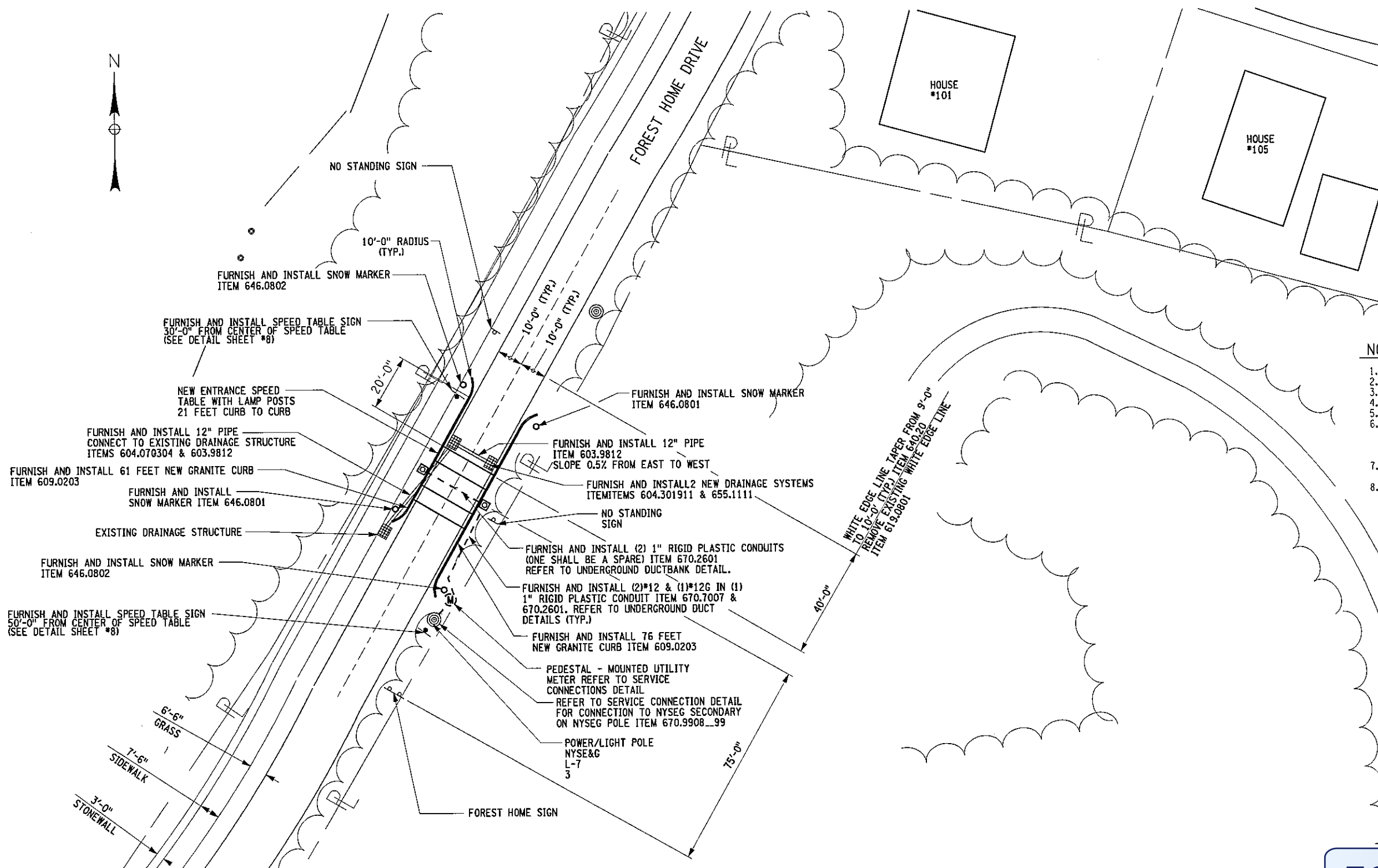

**NOTES**

1. FOR SITE LOCATION PLAN, SEE SHEET #4.
2. FOR LEGEND, SEE SHEET #2.
3. FOR PAVEMENT MARKINGS, SEE SHEET #19.
4. FOR DRAINAGE DETAILS, SEE SHEET #7.
5. FOR ELECTRICAL DETAILS, SEE SHEET #8 & #20.
6. PRIOR TO ANY CONSTRUCTION THE CONTRACTOR SHALL LAYOUT AND MARK THE LOCATION OF EACH SPEED TABLE. NO CONSTRUCTION SHALL BEGIN UNTIL ENGINEER APPROVES MARKED OUT LOCATION.
7. SILT FENCE (ITEM 209.13) SHALL BE USED AT ALL SITES AS DIRECTED BY THE ENGINEER.
8. AT ALL ENTRANCE FEATURES FURNISH AND INSTALL 2 NEW 12'-0" LIGHT POLES AND LED FIXTURES ITEM 670.9901...99.

**FOR COMMENT**

SITE #4 - ENTRANCE FEATURE LAYOUT

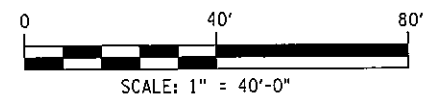

PREPARED BY: ON:	ALTERED BY: ON:
AS BUILT REVISIONS DESCRIPTION OF WORK:	
SIGNATURE	DATE
DOCUMENT NAME:	

FOREST HOME TRAFFIC CALMING - PHASE I	PIN 375509
TOWN OF ITHACA	
COUNTY: TOMPKINS	
	

ALL DIMENSIONS IN FT UNLESS OTHERWISE NOTED	CONTRACT NUMBER
SITE #4 - ENTRANCE FEATURE LAYOUT	
FOREST HOME TRAFFIC CALMING PHASE I	SHEET NO. 12
NEW YORK STATE DEPARTMENT OF TRANSPORTATION REGION 3	

IT IS A VIOLATION OF LAW FOR ANY PERSON, UNLESS THEY ARE ACTING UNDER THE DIRECTION OF A LICENSED PROFESSIONAL ENGINEER, ARCHITECT, LANDSCAPE ARCHITECT OR LAND SURVEYOR TO ALTER AN ITEM IN ANY WAY. IF AN ITEM BEARING THE STAMP OF A LICENSED PROFESSIONAL IS ALTERED, THE ALTERING ENGINEER, ARCHITECT, LANDSCAPE ARCHITECT OR LAND SURVEYOR SHALL STAMP THE DOCUMENT AND INCLUDE THE NOTATION "ALTERED BY" FOLLOWED BY THEIR SIGNATURE, THE DATE OF SUCH ALTERATION, AND A SPECIFIC DESCRIPTION OF THE ALTERATION.

FILE NAME: M:\1738400 FOREST HOME\HYDRA\DRAW\40 SCALE PLANS\1738400\_05.DGN  
 DATE/TIME: DGN\$SYTIME\$0123456  
 USER: DGN\$USER\$NAME  
 DESIGN SUPERVISOR: WRM

CHECKED BY: WRM  
 DRAFTED BY: JRB  
 ESTIMATED BY: JRB  
 CHECKED BY: WRM  
 DESIGNED BY: TRH  
 JOB MANAGER: WRM

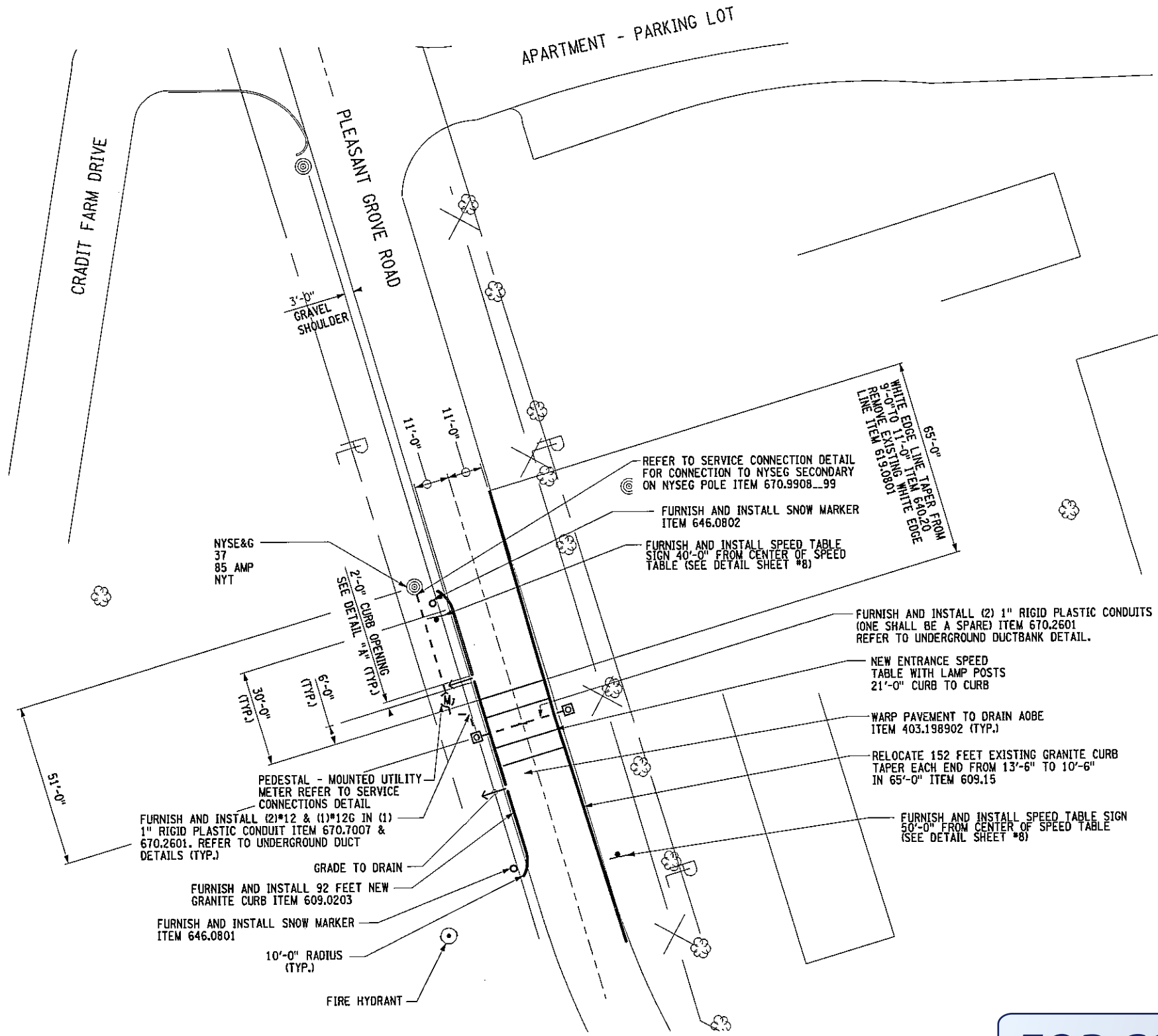

- NOTES**
1. FOR SITE LOCATION PLAN, SEE SHEET #4.
  2. FOR LEGEND, SEE SHEET #2.
  3. FOR PAVEMENT MARKINGS, SEE SHEET #19.
  4. FOR DRAINAGE DETAILS, SEE SHEET #7.
  5. FOR ELECTRICAL DETAILS, SEE SHEET #8 & #20.
  6. PRIOR TO ANY CONSTRUCTION THE CONTRACTOR SHALL LAYOUT AND MARK THE LOCATION OF EACH SPEED TABLE. NO CONSTRUCTION SHALL BEGIN UNTIL ENGINEER APPROVES MARKED OUT LOCATION.
  7. SILT FENCE (ITEM 209.13) SHALL BE USED AT ALL SITES AS DIRECTED BY THE ENGINEER.
  8. AT ALL ENTRANCE FEATURES FURNISH AND INSTALL 2 NEW 12'-0" LIGHT POLES AND LED FIXTURES ITEM 670.9901..99.

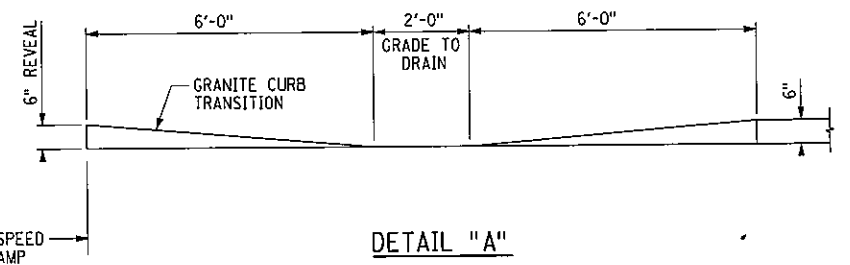

**DETAIL "A"**  
 CURB TRANSITION TO DRAINAGE OUTLET  
 NOT TO SCALE

**FOR COMMENT**

**SITE #5 - ENTRANCE FEATURE LAYOUT**

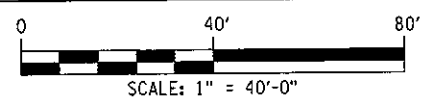

PREPARED BY: ON:	ALTERED BY: ON:
AS BUILT REVISIONS DESCRIPTION OF WORK:	
SIGNATURE	DATE
DOCUMENT NAME:	

FOREST HOME TRAFFIC CALMING - PHASE I	PIN 375509	CONTRACT NUMBER
TOWN OF ITHACA		SHEET NO. 13
COUNTY: TOMPKINS		
ALL DIMENSIONS IN FT UNLESS OTHERWISE NOTED <b>SITE #5 - ENTRANCE FEATURE LAYOUT</b> FOREST HOME TRAFFIC CALMING PHASE I		NEW YORK STATE DEPARTMENT OF TRANSPORTATION REGION 3

IT IS A VIOLATION OF LAW FOR ANY PERSON, UNLESS THEY ARE ACTING UNDER THE DIRECTION OF A LICENSED PROFESSIONAL ENGINEER, ARCHITECT, LANDSCAPE ARCHITECT OR LAND SURVEYOR TO ALTER AN ITEM IN ANY WAY. IF AN ITEM BEARING THE STAMP OF A LICENSED PROFESSIONAL IS ALTERED, THE ALTERING ENGINEER, ARCHITECT, LANDSCAPE ARCHITECT OR LAND SURVEYOR SHALL STAMP THE DOCUMENT AND INCLUDE THE NOTATION "ALTERED BY" FOLLOWED BY THEIR SIGNATURE, THE DATE OF SUCH ALTERATION, AND A SPECIFIC DESCRIPTION OF THE ALTERATION.



FILE NAME: M:\1738400 FOREST HOME\W\W\DRAW\40 SCALE PLANS\1738400\_S7.DGN  
 DATE/TIME: DDMMSS\TIME\0123456  
 USER: DGN\USERNAME

DESIGN SUPERVISOR: WRM JOB MANAGER: WRM DESIGNED BY: TRH CHECKED BY: WRM DRAFTED BY: JRB ESTIMATED BY: JRB CHECKED BY: WRM

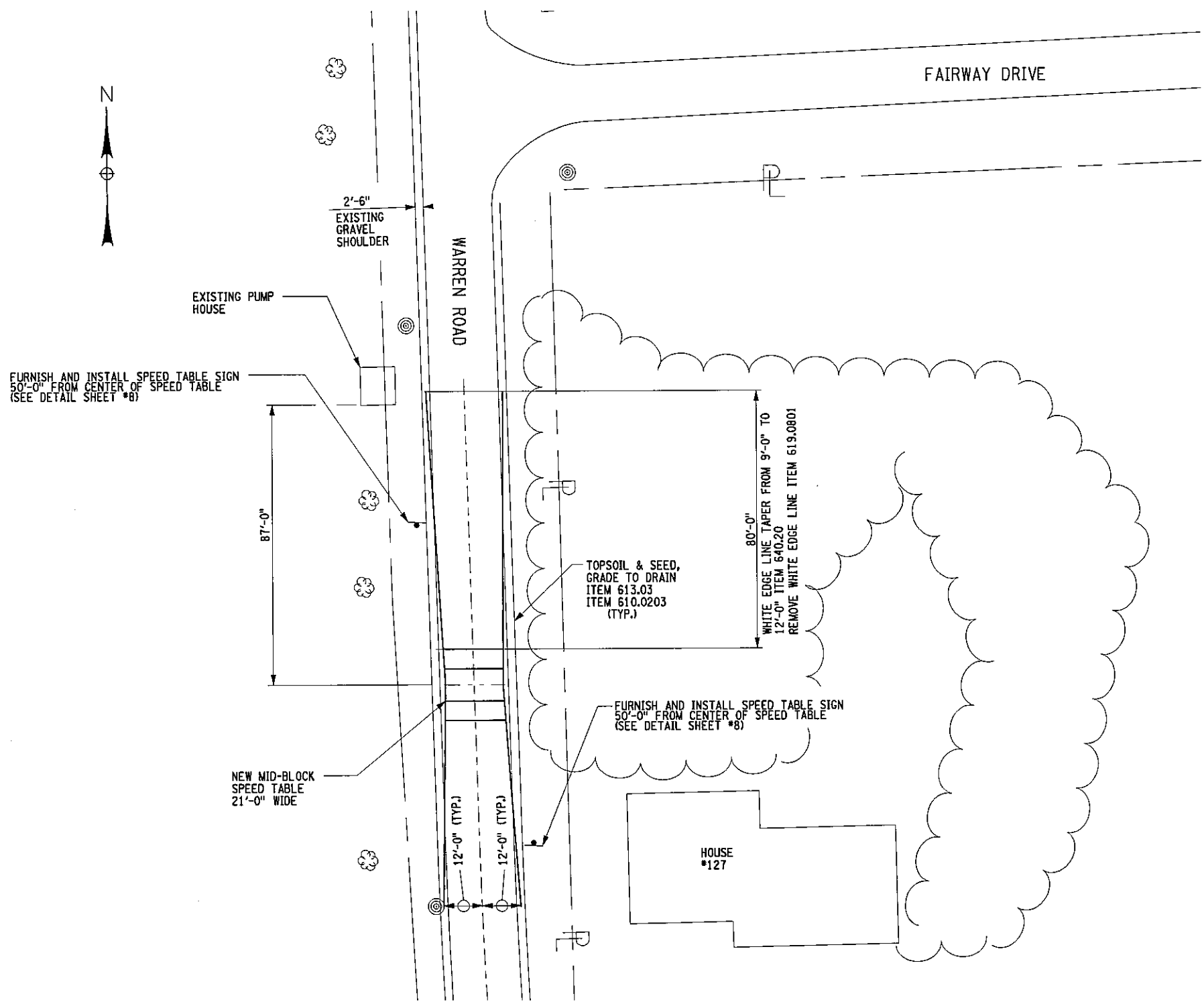

**NOTES**

1. FOR SITE LOCATION PLAN, SEE SHEET #4.
2. FOR LEGEND, SEE SHEET #2.
3. FOR PAYMENT MARKINGS, SEE SHEET #19.
4. FOR DRAINAGE DETAILS, SEE SHEET #7.
5. PRIOR TO ANY CONSTRUCTION THE CONTRACTOR SHALL LAYOUT AND MARK THE LOCATION OF EACH SPEED TABLE. NO CONSTRUCTION SHALL BEGIN UNTIL ENGINEER APPROVES MARKED OUT LOCATION.
6. SILT FENCE (ITEM 209.13) SHALL BE USED AT ALL SITES AS DIRECTED BY THE ENGINEER.

FOR COMMENT

**SITE #7 MID-BLOCK SPEED TABLE LAYOUT**

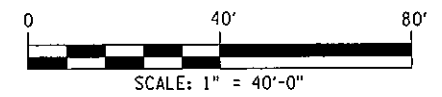

IT IS A VIOLATION OF LAW FOR ANY PERSON, UNLESS THEY ARE ACTING UNDER THE DIRECTION OF A LICENSED PROFESSIONAL ENGINEER, ARCHITECT, LANDSCAPE ARCHITECT OR LAND SURVEYOR TO ALTER AN ITEM IN ANY WAY. IF AN ITEM BEARING THE STAMP OF A LICENSED PROFESSIONAL IS ALTERED, THE ALTERING ENGINEER, ARCHITECT, LANDSCAPE ARCHITECT OR LAND SURVEYOR SHALL STAMP THE DOCUMENT AND INCLUDE THE NOTATION "ALTERED BY" FOLLOWED BY THEIR SIGNATURE, THE DATE OF SUCH ALTERATION, AND A SPECIFIC DESCRIPTION OF THE ALTERATION.

PREPARED BY: ON:	ALTERED BY: ON:

AS BUILT REVISIONS  
DESCRIPTION OF WORK:

SIGNATURE \_\_\_\_\_ DATE \_\_\_\_\_

DOCUMENT NAME:

FOREST HOME TRAFFIC CALMING - PHASE I

TOWN OF ITHACA

COUNTY: TOMPKINS



PIN 375509

ALL DIMENSIONS IN FT UNLESS OTHERWISE NOTED	CONTRACT NUMBER
<b>SITE #7 - MID-BLOCK SPEED TABLE LAYOUT</b> FOREST HOME TRAFFIC CALMING PHASE I	SHEET NO. 15



FILE NAME: H:\1738400 FOREST HOME\HY\DRAW\40 SCALE PLANS\1738400\_59.DGN  
 DATE/TIME: =DCN\$SYTIME0123456  
 USER: =DCN\$USERNAME

DESIGN SUPERVISOR: WRM JOB MANAGER: WRM DESIGNED BY: TRH CHECKED BY: WRM DRAFTED BY: JRB ESTIMATED BY: JRB CHECKED BY: JRB

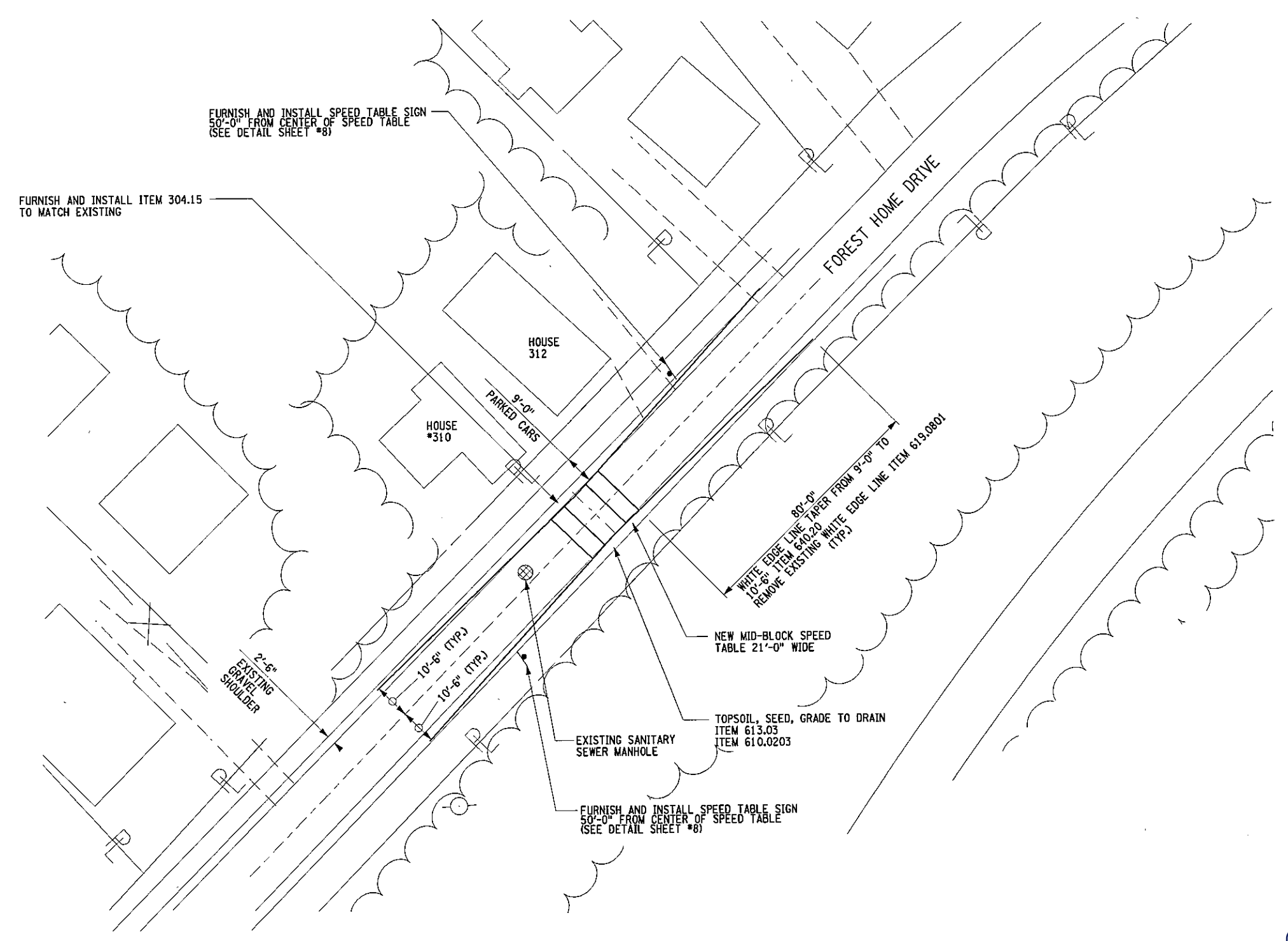

- NOTES**
1. FOR SITE LOCATION PLAN, SEE SHEET #4.
  2. FOR LEGEND, SEE SHEET #2.
  3. FOR PAVEMENT MARKINGS, SEE SHEET #19.
  4. FOR DRAINAGE DETAILS, SEE SHEET #7.
  5. PRIOR TO ANY CONSTRUCTION THE CONTRACTOR SHALL LAYOUT AND MARK THE LOCATION OF EACH SPEED TABLE. NO CONSTRUCTION SHALL BEGIN UNTIL ENGINEER APPROVES MARKED OUT LOCATION.
  6. SILT FENCE (ITEM 209.13) SHALL BE USED AT ALL SITES AS DIRECTED BY THE ENGINEER.

**SITE #9 - MID-BLOCK SPEED TABLE LAYOUT**

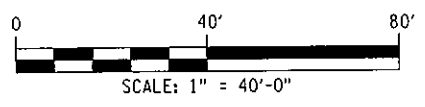

**FOR COMMENT**

IT IS A VIOLATION OF LAW FOR ANY PERSON, UNLESS THEY ARE ACTING UNDER THE DIRECTION OF A LICENSED PROFESSIONAL ENGINEER, ARCHITECT, LANDSCAPE ARCHITECT OR LAND SURVEYOR TO ALTER AN ITEM IN ANY WAY. IF AN ITEM BEARING THE STAMP OF A LICENSED PROFESSIONAL IS ALTERED, THE ALTERING ENGINEER, ARCHITECT, LANDSCAPE ARCHITECT OR LAND SURVEYOR SHALL STAMP THE DOCUMENT AND INCLUDE THE NOTATION "ALTERED BY" FOLLOWED BY THEIR SIGNATURE, THE DATE OF SUCH ALTERATION, AND A SPECIFIC DESCRIPTION OF THE ALTERATION.

PREPARED BY: ON:	ALTERED BY: ON:

AS BUILT REVISIONS DESCRIPTION OF WORK:	FOREST HOME TRAFFIC CALMING - PHASE I
SIGNATURE _____	DATE _____
DOCUMENT NAME:	

TOWN OF ITHACA  
 COUNTY: TOMPKINS

PIN 375509			
------------	--	--	--

ALL DIMENSIONS IN FT UNLESS OTHERWISE NOTED	CONTRACT NUMBER
<b>SITE #9 - MID-BLOCK SPEED TABLE LAYOUT</b> FOREST HOME TRAFFIC CALMING PHASE I	SHEET NO. 17

FILE NAME: M:\1738400 FOREST HOME\HWY\DRAW\40 SCALE PLANS\1738400\_S10.DGN  
 DATE/TIME: 06/05/2011 01:23:45  
 USER: DGN\$USER\$NAME

WRM CHECKED BY JRB DRAFTED BY JRB ESTIMATED BY WRM CHECKED BY TRH DESIGNED BY WRM JOB MANAGER WRM DESIGN SUPERVISOR

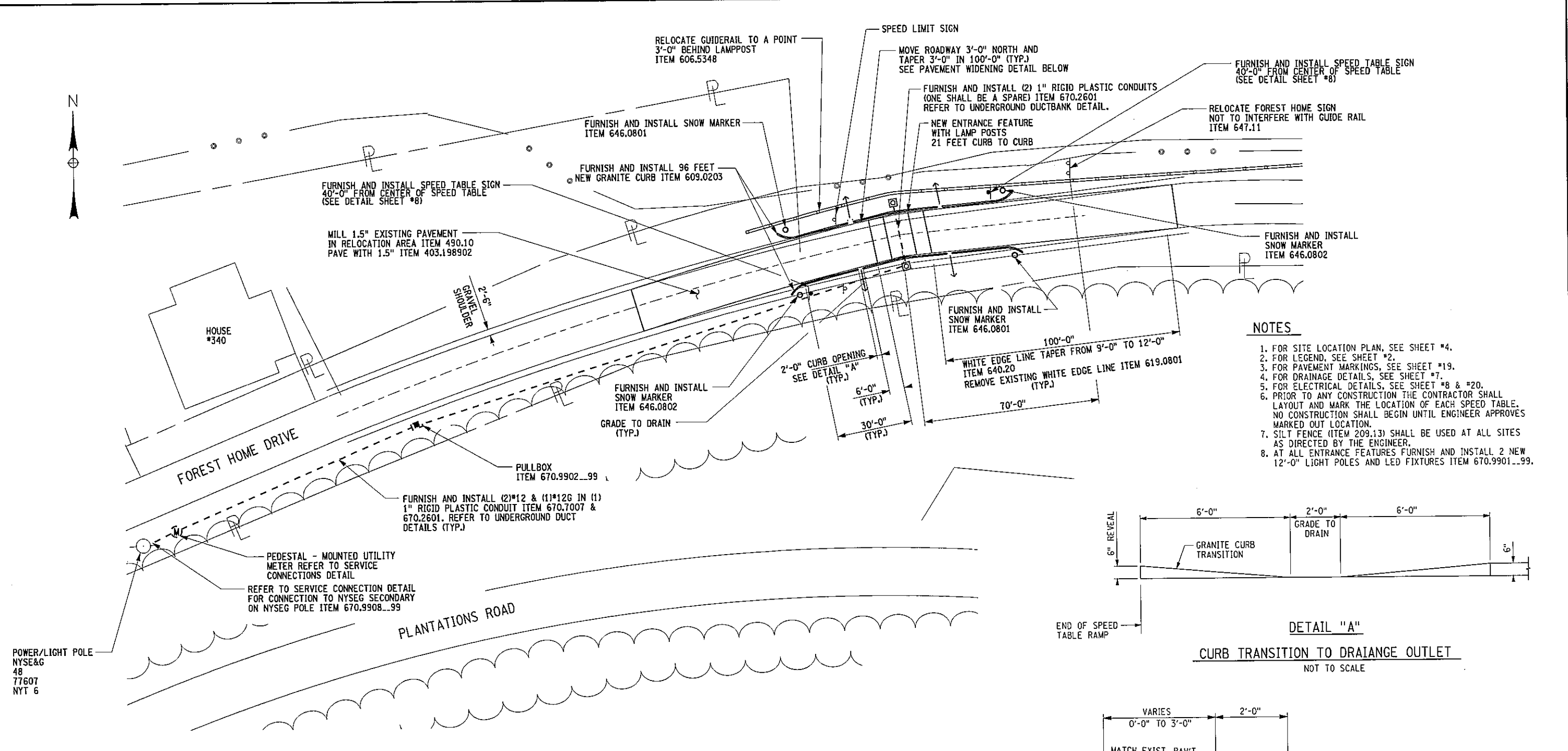

- NOTES**
1. FOR SITE LOCATION PLAN, SEE SHEET #4.
  2. FOR LEGEND, SEE SHEET #2.
  3. FOR PAVEMENT MARKINGS, SEE SHEET #19.
  4. FOR DRAINAGE DETAILS, SEE SHEET #7.
  5. FOR ELECTRICAL DETAILS, SEE SHEET #8 & #20.
  6. PRIOR TO ANY CONSTRUCTION THE CONTRACTOR SHALL LAYOUT AND MARK THE LOCATION OF EACH SPEED TABLE. NO CONSTRUCTION SHALL BEGIN UNTIL ENGINEER APPROVES MARKED OUT LOCATION.
  7. SILT FENCE (ITEM 209.13) SHALL BE USED AT ALL SITES AS DIRECTED BY THE ENGINEER.
  8. AT ALL ENTRANCE FEATURES FURNISH AND INSTALL 2 NEW 12'-0" LIGHT POLES AND LED FIXTURES ITEM 670.9901...99.

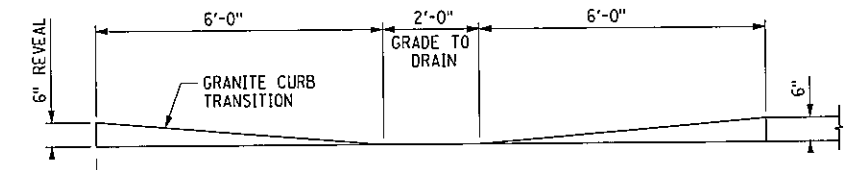

**DETAIL "A"**  
 CURB TRANSITION TO DRAINAGE OUTLET  
 NOT TO SCALE

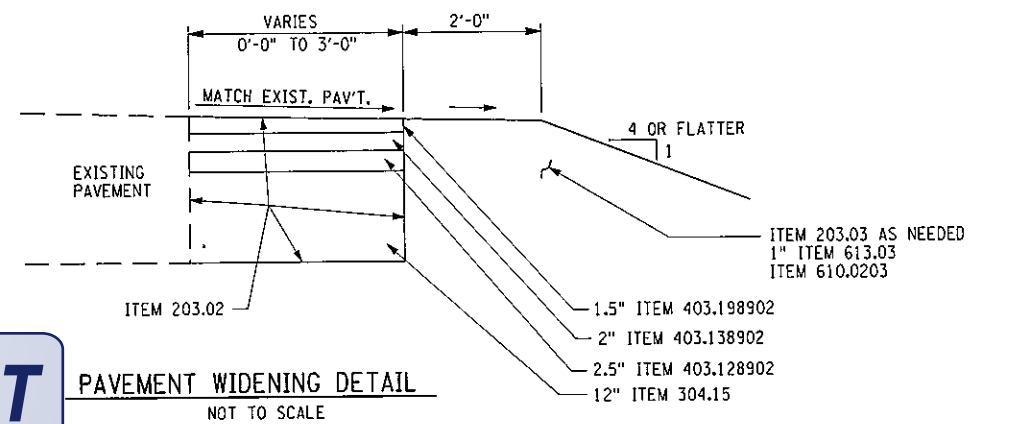

**PAVEMENT WIDENING DETAIL**  
 NOT TO SCALE

**SITE #10 - ENTRANCE FEATURE LAYOUT**

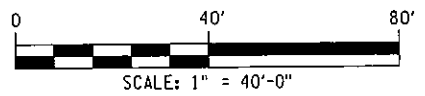

PREPARED BY: ON:	ALTERED BY: ON:
IT IS A VIOLATION OF LAW FOR ANY PERSON, UNLESS THEY ARE ACTING UNDER THE DIRECTION OF A LICENSED PROFESSIONAL ENGINEER, ARCHITECT, LANDSCAPE ARCHITECT OR LAND SURVEYOR TO ALTER AN ITEM IN ANY WAY. IF AN ITEM BEARING THE STAMP OF A LICENSED PROFESSIONAL IS ALTERED, THE ALTERING ENGINEER, ARCHITECT, LANDSCAPE ARCHITECT OR LAND SURVEYOR SHALL STAMP THE DOCUMENT AND INCLUDE THE NOTATION "ALTERED BY" FOLLOWED BY THEIR SIGNATURE, THE DATE OF SUCH ALTERATION, AND A SPECIFIC DESCRIPTION OF THE ALTERATION.	
SIGNATURE	DATE
DOCUMENT NAME:	

AS BUILT REVISIONS DESCRIPTION OF WORK:	FOREST HOME TRAFFIC CALMING - PHASE I

TOWN OF ITHACA COUNTY: TOMPKINS	PIN 375509



ALL DIMENSIONS IN FT UNLESS OTHERWISE NOTED	CONTRACT NUMBER
<b>SITE # 10 - ENTRANCE FEATURE LAYOUT</b> FOREST HOME TRAFFIC CALMING PHASE I	SHEET NO. 18
NEW YORK STATE DEPARTMENT OF TRANSPORTATION REGION 3	

FILE NAME: H:\1738400\_FOREST HOME\H\1738400\_PAV\_MRK.DGN  
 DATE/TIME: 08/21/2014 12:34:56  
 USER: DGNUSERNAME  
 DESIGN SUPERVISOR: WRM

WRM CHECKED BY  
 JRB DRAFTED BY  
 JRB ESTIMATED BY  
 WRM CHECKED BY  
 TRH DESIGNED BY  
 WRM JOB MANAGER  
 WRM

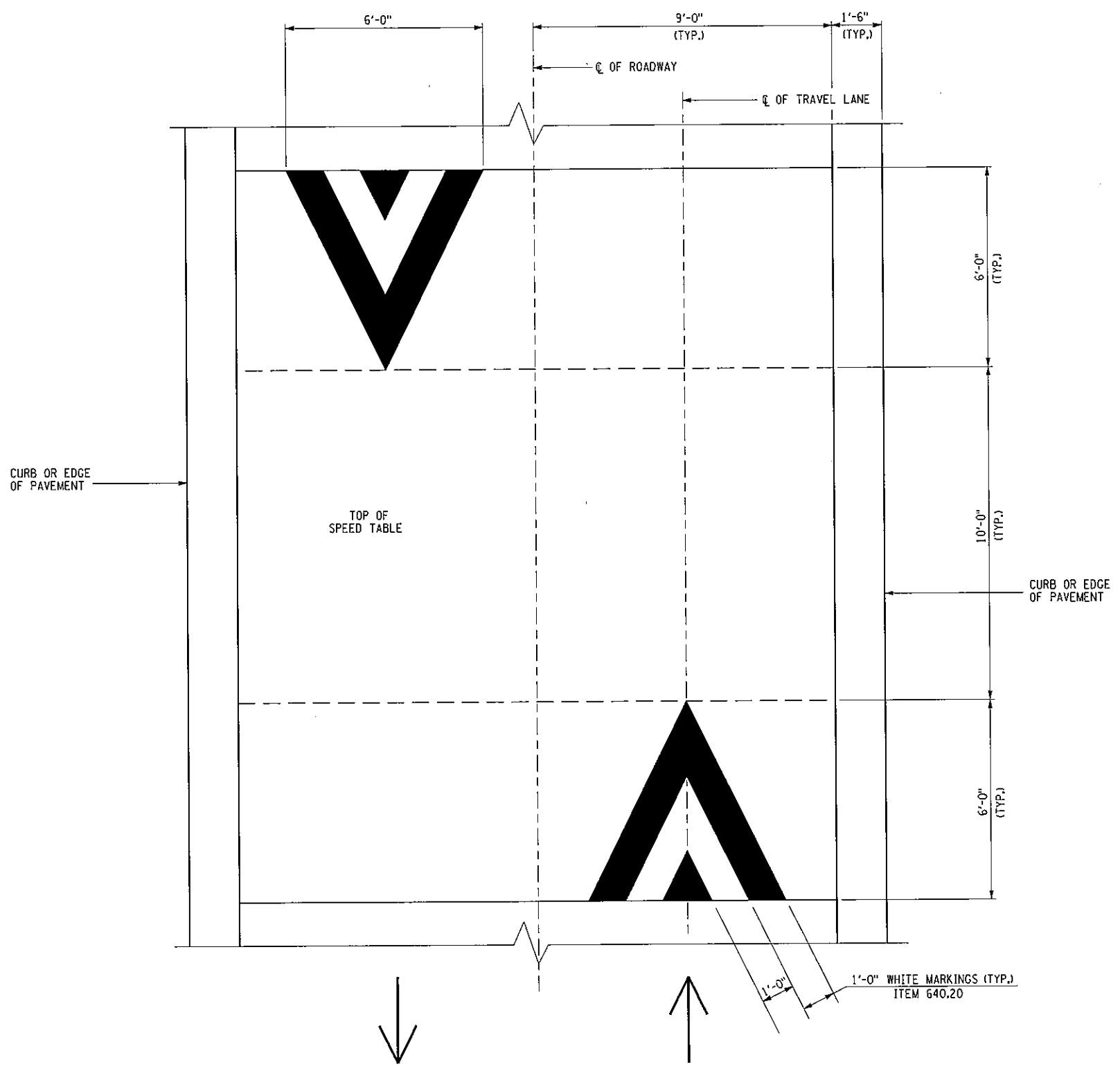

**NOTES**  
 1. WORK THIS DRAWING WITH DRAWING #9 THRU #18.

**LEGEND**  
 → DIRECTION OF TRAVEL

**TYPICAL PAVEMENT MARKINGS**  
 SCALE: 1/4" = 1'-0"

**FOR COMMENT**

IT IS A VIOLATION OF LAW FOR ANY PERSON, UNLESS THEY ARE ACTING UNDER THE DIRECTION OF A LICENSED PROFESSIONAL ENGINEER, ARCHITECT, LANDSCAPE ARCHITECT OR LAND SURVEYOR TO ALTER AN ITEM IN ANY WAY. IF AN ITEM BEARING THE STAMP OF A LICENSED PROFESSIONAL IS ALTERED, THE ALTERING ENGINEER, ARCHITECT, LANDSCAPE ARCHITECT OR LAND SURVEYOR SHALL STAMP THE DOCUMENT AND INCLUDE THE NOTATION "ALTERED BY" FOLLOWED BY THEIR SIGNATURE, THE DATE OF SUCH ALTERATION, AND A SPECIFIC DESCRIPTION OF THE ALTERATION.

PREPARED BY: ON:	ALTERED BY: ON:

AS BUILT REVISIONS DESCRIPTION OF WORK:	FOREST HOME TRAFFIC CALMING - PHASE I
SIGNATURE _____	TOWN OF ITHACA
DATE _____	COUNTY: TOMPKINS
DOCUMENT NAME:	

PIN 375509



--	--	--	--

ALL DIMENSIONS IN FT UNLESS OTHERWISE NOTED	CONTRACT NUMBER
<b>TYPICAL PAVEMENT MARKINGS</b>	
FOREST HOME TRAFFIC CALMING PHASE I	SHEET NO. 19

